

TEST REPORT

CLIENT DETAILS

Client Name: Zhangjiagang City Yefeng Knitting Co., Ltd.
Client Contact: Angel
Telephone: 13701560309
Email: angel@asianglory.net
Address: No.18 Shilong Road, Fenghuang Town, Zhangjiagang City

LABORATORY DETAILS

SGS Affiliate: SGS-CSTC Ltd.
SGS Contact: Lily Li
Telephone: +86(021) 61072854
Email: Lily-Li@sgs.com
Address: The 4th Building, No.889, Yishan Road, Xuhui District, Shanghai, China

FACTORY DETAILS

Factory Name: Bozhou Shanshang Textile Technology Co., Ltd.
Factory Contact: Guomao Yang
Telephone: 15006153412
Email: 269546204@qq.com
Address: No.20 Yaodu Avenue, East District, Shanshan Fashion Industrial Park, Qiaocheng District, Bozhou City, Anhui Province
Types of Mills: (3) Fabric Dyeing, Finishing, Washing
(5) Vertical Knit
Discharge Destination: To Centralized Waste Water Treatment Plant
Name of Municipal/Centralized ETP: Bozhou Southern New District Sewage Treatment Plant
Address of Municipal/Centralized ETP: Intersection of National Highway 105 and Huaihua Road, Bozhou Hi-tech Zone

SAMPLE AND TESTING DETAILS

Sampling Country: SGS China SL
ZDHC Sampler's Certification No.: 8F146507053
Sampling Date: 08-07-2021
Sample Received Date: 09-07-2021
Test Performing Period: 09-07-2021 - 22-07-2021
No. of Samples: Water (1); Sludge (1)
Sample Descriptions: 1) Discharged Waste Water (6-hour Composite)
2) Sludge (Grab)
Sample Volume: 1) Discharged Waste Water 20L
2) Sludge 1.5Kg
Testing Institute: SGS China SH Lab
Discharge Method: Indirect Discharge

OVERALL RESULTS

	Discharged Waste Water	Sludge
Conventional Parameters / Anion / Metals:	Please refer to the information in TEST RESULTS	Detected
MRSL Parameters:	Not Detected	Not Detected

REMARKS

1. This test document cannot be reproduced in any way, except in full content, without prior approval in writing by the laboratory.
2. The results shown in this test report refer only to the sampling and the sample(s) tested unless otherwise stated.
3. For indirect discharge, factory performance against ZDHC requirements for conventional parameters, anions and metals for discharged waste water should be compared with the discharged license of the factory.

Signed for and on behalf of

SGS-CSTC Standards Technical Services (Shanghai) Co., Ltd Testing Center

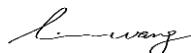

Linda Wang
Chemical Manager

RESULT SUMMARY

Factory Name: Bozhou Shanshang Textile Technology Co., Ltd.
 Factory Address: No.20 Yaodu Avenue, East District,
 Shanshan Fashion Industrial Park, Qiaocheng District,
 Bozhou City, Anhui Province

TEST ITEMS	Discharged Waste Water	Sludge
Conventional Parameters	Please refer to the information in TEST RESULTS	-
Anions	X	O
Metals	X	X
Alkylphenols (APs) and Alkylphenol Ethoxylates (APEOs)	O	O
Chlorobenzenes and Chlorotoluenes (COCs)	O	O
Chlorophenols	O	O
Azo dyes	O	O
Carcinogenic dyes	O	O
Disperse dyes	O	O
Flame retardants	O	O
Glycols	O	O
Halogenated solvents	O	O
Organotin Compounds	O	O
Perfluorinated / Polyfluorinated Chemicals (PFCs)	O	O
Phthalates	O	O
Polycyclic Aromatic Hydrocarbons (PAHs)	O	O
Volatile Organic Compounds (VOCs)	O	O

Note:

X - Detected

O - Not Detected

N/A - Not Tested

TEST RESULTS

Factory Name: Bozhou Shanshang Textile Technology Co., Ltd.

Factory Address: No.20 Yaodu Avenue, East District, Shanshan Fashion Industrial Park, Qiaocheng District, Bozhou City, Anhui Province

Sample ID		52115283381201-01		-	-	52115283381201-02		Factory Performances (Refer to Remarks in cover page)	*Local Requirements	
Date of Sampling		08-07-2021		-	-	08-07-2021				
Sampling Location		Discharged waste water outlet		-	-	Sludge stacking place				
Sampling Start Time		10:20		-	-	10:00				
Sampling End Time		16:30		-	-	10:10				
Date of Sample Received		09-07-2021		-	-	09-07-2021				
Items	CAS No.	Reporting Limit	Units	Discharged Waste Water	Reporting Limit	Units	SludgeΦ	Discharged Waste Water	Sludge	Discharged Waste Water
Sample Colour Description	-	-	-	Pale yellowish	-	-	Black	-	-	-
Average Waste Water Flow**	-	-	L/hr	9.83×10 ⁴	-	-	-	-	-	-
Conventional Parameters										
Temp-Difference	-	-	°C	N/A	-	-	-	-	-	N/A
Temp-Discharge Pipe	-	-	°C	29.0	-	-	-	Not Applicable	-	N/A
Temp-Receiving Water ^Δ	-	-	°C	N/A	-	-	-	-	-	N/A
TSS	-	5	mg/L	15	-	-	-	Not Applicable	-	N/A
COD	-	10	mg/L	76	-	-	-	Not Applicable	-	N/A
Total Nitrogen (Total-N)	-	5	mg/L	n.d.	-	-	-	Not Applicable	-	N/A
pH Value	-	-	-	7.5	-	-	-	Not Applicable	-	N/A
Colour (436nm; 525nm; 620nm)	-	-	m ⁻¹	5.8; 3.8; 2.8	-	-	-	Not Applicable	-	N/A
BOD (5-day)	-	5	mg/L	n.d.	-	-	-	Not Applicable	-	N/A
Ammonium Nitrogen (Ammonium-N)	-	0.5	mg/L	3.7	-	-	-	Not Applicable	-	N/A
Total Phosphorus (Total-P)	-	0.1	mg/L	0.6	-	-	-	Not Applicable	-	N/A
AOX	-	0.1	mg/L	n.d.	-	-	-	Not Applicable	-	N/A
Oil and Grease	-	0.5	mg/L	n.d.	-	-	-	Not Applicable	-	N/A
Phenol	-	0.001	mg/L	0.040	-	-	-	Not Applicable	-	N/A
Coliform	-	25	Bacteria / 100ml	28	-	-	-	Not Applicable	-	N/A
Persistent Foam	-	Not Visible	-	Not Visible	-	-	-	Not Applicable	-	N/A
Anions										
Cyanide	-	0.05	mg/L	n.d.	1	mg/kg	n.d. (<4mg/kg) ¹	Not Applicable	Not Detected	N/A
Sulfide	-	0.01	mg/L	0.12	-	-	-	Not Applicable	-	N/A

TEST RESULTS

Factory Name: Bozhou Shanshang Textile Technology Co., Ltd.

Factory Address: No.20 Yaodu Avenue, East District, Shanshan Fashion Industrial Park, Qiaocheng District, Bozhou City, Anhui Province

Sample ID		52115283381201-01	-	-	52115283381201-02	Factory Performances (Refer to Remarks in cover page)	*Local Requirements			
Date of Sampling		08-07-2021	-	-	08-07-2021					
Sampling Location		Discharged waste water outlet	-	-	Sludge stacking place					
Sampling Start Time		10:20	-	-	10:00					
Sampling End Time		16:30	-	-	10:10					
Date of Sample Received		09-07-2021	-	-	09-07-2021					
Items	CAS No.	Reporting Limit	Units	Discharged Waste Water	Reporting Limit	Units	Sludge Φ	Discharged Waste Water	Sludge	Discharged Waste Water
Sulfite	-	0.2	mg/L	n.d.($<20.0\text{mg/L}$) ¹	-	-	-	Not Applicable	-	N/A
Metals										
Total Antimony (Sb) [#]	7440-36-0	0.01	mg/L	0.02	-	-	-	Not Applicable	-	N/A
Total Chromium (Cr)	7440-47-3	0.05	mg/L	n.d.	-	-	-	Not Applicable	-	N/A
Total Cobalt (Co)	7440-48-4	0.01	mg/L	n.d.	-	-	-	Not Applicable	-	N/A
Total Copper (Cu)	7440-50-8	0.25	mg/L	n.d.	-	-	-	Not Applicable	-	N/A
Total Nickel (Ni)	7440-02-0	0.05	mg/L	n.d.	-	-	-	Not Applicable	-	N/A
Total Silver (Ag)	7440-22-4	0.005	mg/L	n.d.	-	-	-	Not Applicable	-	N/A
Total Zinc (Zn)	7440-66-6	0.5	mg/L	n.d.	-	-	-	Not Applicable	-	N/A
Total Arsenic (As)	7440-38-2	0.005	mg/L	n.d.	2	mg/kg	4	Not Applicable	Detected	N/A
Total Cadmium (Cd)	7440-43-9	0.01	mg/L	n.d.	2	mg/kg	n.d.	Not Applicable	Not Detected	N/A
Hexavalent Chromium (Cr-VI)	7440-47-3, 18540-29-9	0.001	mg/L	n.d.	2	mg/kg	n.d.	Not Applicable	Not Detected	N/A
Total Lead (Pb)	7439-92-1	0.01	mg/L	n.d.	2	mg/kg	12	Not Applicable	Detected	N/A
Total Mercury (Hg)	7439-97-6	0.001	mg/L	n.d.	0.2	mg/kg	n.d.	Not Applicable	Not Detected	N/A
Alkylphenols (APs) & Alkylphenol Ethoxylates (APEOs)										
Nonylphenol (NP), mixed isomers	Multiple, including 104-40-5, 11066-49-2, 25154-52-3, 84852-15-3, 90481-04-2, 1173019-62-9	5	$\mu\text{g/L}$	n.d.	0.4	mg/kg	n.d.	Not Detected	Not Detected	-
Octylphenol (OP), mixed isomers	Multiple, including 140-66-9, 1806-26-4, 27193-28-8	5	$\mu\text{g/L}$	n.d.	0.4	mg/kg	n.d.	Not Detected	Not Detected	-
Octylphenol ethoxylates (OPEO)	Multiple, including 9002-93-1, 9036-19-5, 68987-90-6	5	$\mu\text{g/L}$	n.d.	0.4	mg/kg	n.d.	Not Detected	Not Detected	-
Nonylphenol ethoxylates (NPEO)	Multiple, including 9016-45-9, 26027-38-3, 37205-87-1, 68412-54-4, 127087-87-0	5	$\mu\text{g/L}$	n.d.	0.4	mg/kg	n.d.	Not Detected	Not Detected	-
Chlorobenzenes & Chlorotoluenes (COCs)										
Monochlorobenzenes	108-90-7	0.2	$\mu\text{g/L}$	n.d.	0.2	mg/kg	n.d.	Not Detected	Not Detected	-
1,2-Dichlorobenzene	95-50-1	0.2	$\mu\text{g/L}$	n.d.	0.2	mg/kg	n.d.	Not Detected	Not Detected	-
1,3-Dichlorobenzene	541-73-1	0.2	$\mu\text{g/L}$	n.d.	0.2	mg/kg	n.d.	Not Detected	Not Detected	-

TEST RESULTS

Factory Name: Bozhou Shanshang Textile Technology Co., Ltd.

Factory Address: No.20 Yaodu Avenue, East District, Shanshan Fashion Industrial Park, Qiaocheng District, Bozhou City, Anhui Province

		Sample ID	52115283381201-01	-	-	52115283381201-02			Factory Performances (Refer to Remarks in cover page)	*Local Requirements
		Date of Sampling	08-07-2021	-	-	08-07-2021				
		Sampling Location	Discharged waste water outlet	-	-	Sludge stacking place				
		Sampling Start Time	10:20	-	-	10:00				
		Sampling End Time	16:30	-	-	10:10				
		Date of Sample Received	09-07-2021	-	-	09-07-2021				
Items	CAS No.	Reporting Limit	Units	Discharged Waste Water	Reporting Limit	Units	SludgeΦ	Discharged Waste Water	Sludge	Discharged Waste Water
1,4-Dichlorobenzene	106-46-7	0.2	µg/L	n.d.	0.2	mg/kg	n.d.	Not Detected	Not Detected	-
1,2,3-Trichlorobenzene	87-61-6	0.2	µg/L	n.d.	0.2	mg/kg	n.d.	Not Detected	Not Detected	-
1,2,4-Trichlorobenzene	120-82-1	0.2	µg/L	n.d.	0.2	mg/kg	n.d.	Not Detected	Not Detected	-
1,3,5-Trichlorobenzene	108-70-3	0.2	µg/L	n.d.	0.2	mg/kg	n.d.	Not Detected	Not Detected	-
1,2,3,4-Tetrachlorobenzene	634-66-2	0.2	µg/L	n.d.	0.2	mg/kg	n.d.	Not Detected	Not Detected	-
1,2,3,5-Tetrachlorobenzene	634-90-2	0.2	µg/L	n.d.	0.2	mg/kg	n.d.	Not Detected	Not Detected	-
1,2,4,5-Tetrachlorobenzene	95-94-3	0.2	µg/L	n.d.	0.2	mg/kg	n.d.	Not Detected	Not Detected	-
Pentachlorobenzene	608-93-5	0.2	µg/L	n.d.	0.2	mg/kg	n.d.	Not Detected	Not Detected	-
Hexachlorobenzene	118-74-1	0.2	µg/L	n.d.	0.2	mg/kg	n.d.	Not Detected	Not Detected	-
2-Chlorotoluene	95-49-8	0.2	µg/L	n.d.	0.2	mg/kg	n.d.	Not Detected	Not Detected	-
3-Chlorotoluene	108-41-8	0.2	µg/L	n.d.	0.2	mg/kg	n.d.	Not Detected	Not Detected	-
4-Chlorotoluene	106-43-4	0.2	µg/L	n.d.	0.2	mg/kg	n.d.	Not Detected	Not Detected	-
2,3-Dichlorotoluene	32768-54-0	0.2	µg/L	n.d.	0.2	mg/kg	n.d.	Not Detected	Not Detected	-
2,4-Dichlorotoluene	95-73-8	0.2	µg/L	n.d.	0.2	mg/kg	n.d.	Not Detected	Not Detected	-
2,5-Dichlorotoluene	19398-61-9	0.2	µg/L	n.d.	0.2	mg/kg	n.d.	Not Detected	Not Detected	-
2,6-Dichlorotoluene	118-69-4	0.2	µg/L	n.d.	0.2	mg/kg	n.d.	Not Detected	Not Detected	-
3,4-Dichlorotoluene	95-75-0	0.2	µg/L	n.d.	0.2	mg/kg	n.d.	Not Detected	Not Detected	-
3,5-Dichlorotoluene	25186-47-4	0.2	µg/L	n.d.	0.2	mg/kg	n.d.	Not Detected	Not Detected	-
2,3,4-Trichlorotoluene	7359-72-0	0.2	µg/L	n.d.	0.2	mg/kg	n.d.	Not Detected	Not Detected	-
2,3,6-Trichlorotoluene	2077-46-5	0.2	µg/L	n.d.	0.2	mg/kg	n.d.	Not Detected	Not Detected	-
2,4,5-Trichlorotoluene	6639-30-1	0.2	µg/L	n.d.	0.2	mg/kg	n.d.	Not Detected	Not Detected	-

TEST RESULTS

Factory Name: Bozhou Shanshang Textile Technology Co., Ltd.

Factory Address: No.20 Yaodu Avenue, East District, Shanshan Fashion Industrial Park, Qiaocheng District, Bozhou City, Anhui Province

		Sample ID	52115283381201-01	-	-	52115283381201-02				*Local Requirements
		Date of Sampling	08-07-2021	-	-	08-07-2021				
		Sampling Location	Discharged waste water outlet	-	-	Sludge stacking place	Factory Performances (Refer to Remarks in cover page)			
		Sampling Start Time	10:20	-	-	10:00				
		Sampling End Time	16:30	-	-	10:10				
		Date of Sample Received	09-07-2021	-	-	09-07-2021				
Items	CAS No.	Reporting Limit	Units	Discharged Waste Water	Reporting Limit	Units	SludgeΦ	Discharged Waste Water	Sludge	Discharged Waste Water
2,4,6-Trichlorotoluene	23749-65-7	0.2	µg/L	n.d.	0.2	mg/kg	n.d.	Not Detected	Not Detected	-
3,4,5-Trichlorotoluene	21472-86-6	0.2	µg/L	n.d.	0.2	mg/kg	n.d.	Not Detected	Not Detected	-
2,3,4,5-Tetrachlorotoluene	76057-12-0	0.2	µg/L	n.d.	0.2	mg/kg	n.d.	Not Detected	Not Detected	-
2,3,5,6-Tetrachlorotoluene	29733-70-8	0.2	µg/L	n.d.	0.2	mg/kg	n.d.	Not Detected	Not Detected	-
2,3,4,6-Tetrachlorotoluene	875-40-1	0.2	µg/L	n.d.	0.2	mg/kg	n.d.	Not Detected	Not Detected	-
Pentachlorotoluene	877-11-2	0.2	µg/L	n.d.	0.2	mg/kg	n.d.	Not Detected	Not Detected	-
Chlorophenols										
2-Chlorophenol	95-57-8	0.5	µg/L	n.d.	0.05	mg/kg	n.d.	Not Detected	Not Detected	-
3-Chlorophenol	108-43-0	0.5	µg/L	n.d.	0.05	mg/kg	n.d.	Not Detected	Not Detected	-
4-Chlorophenol	106-48-9	0.5	µg/L	n.d.	0.05	mg/kg	n.d.	Not Detected	Not Detected	-
2,3-Dichlorophenol	576-24-9	0.5	µg/L	n.d.	0.05	mg/kg	n.d.	Not Detected	Not Detected	-
2,4-Dichlorophenol	120-83-2	0.5	µg/L	n.d.	0.05	mg/kg	n.d.	Not Detected	Not Detected	-
2,5-Dichlorophenol	583-78-8	0.5	µg/L	n.d.	0.05	mg/kg	n.d.	Not Detected	Not Detected	-
2,6-Dichlorophenol	87-65-0	0.5	µg/L	n.d.	0.05	mg/kg	n.d.	Not Detected	Not Detected	-
3,4-Dichlorophenol	95-77-2	0.5	µg/L	n.d.	0.05	mg/kg	n.d.	Not Detected	Not Detected	-
3,5-Dichlorophenol	591-35-5	0.5	µg/L	n.d.	0.05	mg/kg	n.d.	Not Detected	Not Detected	-
2,3,4-Trichlorophenol	15950-66-0	0.5	µg/L	n.d.	0.05	mg/kg	n.d.	Not Detected	Not Detected	-
2,3,5-Trichlorophenol	933-78-8	0.5	µg/L	n.d.	0.05	mg/kg	n.d.	Not Detected	Not Detected	-
2,3,6-Trichlorophenol	933-75-5	0.5	µg/L	n.d.	0.05	mg/kg	n.d.	Not Detected	Not Detected	-
2,4,5-Trichlorophenol	95-95-4	0.5	µg/L	n.d.	0.05	mg/kg	n.d.	Not Detected	Not Detected	-
2,4,6-Trichlorophenol	88-06-2	0.5	µg/L	n.d.	0.05	mg/kg	n.d.	Not Detected	Not Detected	-
3,4,5-Trichlorophenol	609-19-8	0.5	µg/L	n.d.	0.05	mg/kg	n.d.	Not Detected	Not Detected	-

TEST RESULTS

Factory Name: Bozhou Shanshang Textile Technology Co., Ltd.

Factory Address: No.20 Yaodu Avenue, East District, Shanshan Fashion Industrial Park, Qiaocheng District, Bozhou City, Anhui Province

		Sample ID	52115283381201-01	-	-	52115283381201-02				
		Date of Sampling	08-07-2021	-	-	08-07-2021				
		Sampling Location	Discharged waste water outlet	-	-	Sludge stacking place	Factory Performances (Refer to Remarks in cover page)	*Local Requirements		
		Sampling Start Time	10:20	-	-	10:00				
		Sampling End Time	16:30	-	-	10:10				
		Date of Sample Received	09-07-2021	-	-	09-07-2021				
Items	CAS No.	Reporting Limit	Units	Discharged Waste Water	Reporting Limit	Units	SludgeΦ	Discharged Waste Water	Sludge	Discharged Waste Water
2,3,4,5-Tetrachlorophenol	4901-51-3	0.5	µg/L	n.d.	0.05	mg/kg	n.d.	Not Detected	Not Detected	-
2,3,4,6-Tetrachlorophenol	58-90-2	0.5	µg/L	n.d.	0.05	mg/kg	n.d.	Not Detected	Not Detected	-
2,3,5,6-Tetrachlorophenol	935-95-5	0.5	µg/L	n.d.	0.05	mg/kg	n.d.	Not Detected	Not Detected	-
Pentachlorophenol	87-86-5	0.5	µg/L	n.d.	0.05	mg/kg	n.d.	Not Detected	Not Detected	-
Azo Dyes										
4,4'-Methylene-Bis(2-Chloroaniline)	101-14-4	0.1	µg/L	n.d.	0.2	mg/kg	n.d.	Not Detected	Not Detected	-
4,4'-Diaminodiphenylmethane	101-77-9	0.1	µg/L	n.d.	0.2	mg/kg	n.d.	Not Detected	Not Detected	-
4,4'-Oxydianiline	101-80-4	0.1	µg/L	n.d.	0.2	mg/kg	n.d.	Not Detected	Not Detected	-
p-Chloroaniline	106-47-8	0.1	µg/L	n.d.	0.2	mg/kg	n.d.	Not Detected	Not Detected	-
3,3'-Dimethoxybenzidine	119-90-4	0.1	µg/L	n.d.	0.2	mg/kg	n.d.	Not Detected	Not Detected	-
3,3'-Dimethylbenzidine	119-93-7	0.1	µg/L	n.d.	0.2	mg/kg	n.d.	Not Detected	Not Detected	-
p-Cresidine	120-71-8	0.1	µg/L	n.d.	0.2	mg/kg	n.d.	Not Detected	Not Detected	-
2,4,5-Trimethylaniline	137-17-7	0.1	µg/L	n.d.	0.2	mg/kg	n.d.	Not Detected	Not Detected	-
4,4'-Thiodianiline	139-65-1	0.1	µg/L	n.d.	0.2	mg/kg	n.d.	Not Detected	Not Detected	-
p-Aminoazobenzene	60-09-3	0.1	µg/L	n.d.	0.2	mg/kg	n.d.	Not Detected	Not Detected	-
2,4-Diaminoanisole	615-05-4	0.1	µg/L	n.d.	0.2	mg/kg	n.d.	Not Detected	Not Detected	-
3,3'-Dimethyl-4,4'-diaminodiphenylmethane	838-88-0	0.1	µg/L	n.d.	0.2	mg/kg	n.d.	Not Detected	Not Detected	-
2,6-Xylidine	87-62-7	0.1	µg/L	n.d.	0.2	mg/kg	n.d.	Not Detected	Not Detected	-
o-Anisidine	90-04-0	0.1	µg/L	n.d.	0.2	mg/kg	n.d.	Not Detected	Not Detected	-
2-Naphthylamine	91-59-8	0.1	µg/L	n.d.	0.2	mg/kg	n.d.	Not Detected	Not Detected	-
3,3'-Dichlorobenzidine	91-94-1	0.1	µg/L	n.d.	0.2	mg/kg	n.d.	Not Detected	Not Detected	-
4-Aminodiphenyl	92-67-1	0.1	µg/L	n.d.	0.2	mg/kg	n.d.	Not Detected	Not Detected	-

TEST RESULTS

Factory Name: Bozhou Shanshang Textile Technology Co., Ltd.

Factory Address: No.20 Yaodu Avenue, East District, Shanshan Fashion Industrial Park, Qiaocheng District, Bozhou City, Anhui Province

Sample ID		52115283381201-01		-	-	52115283381201-02		Factory Performances (Refer to Remarks in cover page)			*Local Requirements
Date of Sampling		08-07-2021		-	-	08-07-2021					
Sampling Location		Discharged waste water outlet		-	-	Sludge stacking place					
Sampling Start Time		10:20		-	-	10:00					
Sampling End Time		16:30		-	-	10:10					
Date of Sample Received		09-07-2021		-	-	09-07-2021					
Items	CAS No.	Reporting Limit	Units	Discharged Waste Water	Reporting Limit	Units	SludgeΦ	Discharged Waste Water	Sludge	Discharged Waste Water	
Benzidine	92-87-5	0.1	µg/L	n.d.	0.2	mg/kg	n.d.	Not Detected	Not Detected	-	
o-Toluidine	95-53-4	0.1	µg/L	n.d.	0.2	mg/kg	n.d.	Not Detected	Not Detected	-	
2,4-Xylidine	95-68-1	0.1	µg/L	n.d.	0.2	mg/kg	n.d.	Not Detected	Not Detected	-	
4-Chloro-o-Toluidine	95-69-2	0.1	µg/L	n.d.	0.2	mg/kg	n.d.	Not Detected	Not Detected	-	
2,4-Toluylenediamine	95-80-7	0.1	µg/L	n.d.	0.2	mg/kg	n.d.	Not Detected	Not Detected	-	
o-Aminoazotoluene	97-56-3	0.1	µg/L	n.d.	0.2	mg/kg	n.d.	Not Detected	Not Detected	-	
2-Amino-4-Nitrotoluene	99-55-8	0.1	µg/L	n.d.	0.2	mg/kg	n.d.	Not Detected	Not Detected	-	
Carcinogenic Dyes											
Direct Black 38	1937-37-7	500	µg/L	n.d.	10	mg/kg	n.d.	Not Detected	Not Detected	-	
Direct Blue 6	2602-46-2	500	µg/L	n.d.	10	mg/kg	n.d.	Not Detected	Not Detected	-	
Acid Red 26	3761-53-3	500	µg/L	n.d.	10	mg/kg	n.d.	Not Detected	Not Detected	-	
Basic Red 9	569-61-9	500	µg/L	n.d.	10	mg/kg	n.d.	Not Detected	Not Detected	-	
Direct Red 28	573-58-0	500	µg/L	n.d.	10	mg/kg	n.d.	Not Detected	Not Detected	-	
Basic Violet 14	632-99-5	500	µg/L	n.d.	10	mg/kg	n.d.	Not Detected	Not Detected	-	
Disperse Blue 1	2475-45-8	500	µg/L	n.d.	10	mg/kg	n.d.	Not Detected	Not Detected	-	
Disperse Blue 3	2475-46-9	500	µg/L	n.d.	10	mg/kg	n.d.	Not Detected	Not Detected	-	
Basic Blue 26	2580-56-5	500	µg/L	n.d.	10	mg/kg	n.d.	Not Detected	Not Detected	-	
Basic Green 4 (malachite green chloride)^	569-64-2	500	µg/L	n.d.	10	mg/kg	n.d.	Not Detected	Not Detected	-	
Basic Green 4 (malachite green oxalate)^	2437-29-8	500	µg/L	n.d.	10	mg/kg	n.d.	Not Detected	Not Detected	-	
Basic Green 4 (malachite green)	10309-95-2	500	µg/L	n.d.	10	mg/kg	n.d.	Not Detected	Not Detected	-	
Disperse Orange 11	82-28-0	500	µg/L	n.d.	10	mg/kg	n.d.	Not Detected	Not Detected	-	
Disperse Dyes											

TEST RESULTS

Factory Name: Bozhou Shanshang Textile Technology Co., Ltd.

Factory Address: No.20 Yaodu Avenue, East District, Shanshan Fashion Industrial Park, Qiaocheng District, Bozhou City, Anhui Province

		Sample ID	52115283381201-01	-	-	52115283381201-02				
		Date of Sampling	08-07-2021	-	-	08-07-2021				
		Sampling Location	Discharged waste water outlet	-	-	Sludge stacking place	Factory Performances (Refer to Remarks in cover page)	*Local Requirements		
		Sampling Start Time	10:20	-	-	10:00				
		Sampling End Time	16:30	-	-	10:10				
		Date of Sample Received	09-07-2021	-	-	09-07-2021				
Items	CAS No.	Reporting Limit	Units	Discharged Waste Water	Reporting Limit	Units	SludgeΦ	Discharged Waste Water	Sludge	Discharged Waste Water
Disperse Yellow 1	119-15-3	50	µg/L	n.d.	2	mg/kg	n.d.	Not Detected	Not Detected	-
Disperse Blue 102	12222-97-8	50	µg/L	n.d.	2	mg/kg	n.d.	Not Detected	Not Detected	-
Disperse Blue 106	12223-01-7	50	µg/L	n.d.	2	mg/kg	n.d.	Not Detected	Not Detected	-
Disperse Yellow 39	12236-29-2	50	µg/L	n.d.	2	mg/kg	n.d.	Not Detected	Not Detected	-
Disperse Orange 37/59/76	13301-61-6	50	µg/L	n.d.	2	mg/kg	n.d.	Not Detected	Not Detected	-
Disperse Brown 1	23355-64-8	50	µg/L	n.d.	2	mg/kg	n.d.	Not Detected	Not Detected	-
Disperse Orange 1	2581-69-3	50	µg/L	n.d.	2	mg/kg	n.d.	Not Detected	Not Detected	-
Disperse Yellow 3	2832-40-8	50	µg/L	n.d.	2	mg/kg	n.d.	Not Detected	Not Detected	-
Disperse Red 11	2872-48-2	50	µg/L	n.d.	2	mg/kg	n.d.	Not Detected	Not Detected	-
Disperse Red 1	2872-52-8	50	µg/L	n.d.	2	mg/kg	n.d.	Not Detected	Not Detected	-
Disperse Red 17	3179-89-3	50	µg/L	n.d.	2	mg/kg	n.d.	Not Detected	Not Detected	-
Disperse Blue 7	3179-90-6	50	µg/L	n.d.	2	mg/kg	n.d.	Not Detected	Not Detected	-
Disperse Blue 26	3860-63-7	50	µg/L	n.d.	2	mg/kg	n.d.	Not Detected	Not Detected	-
Disperse Yellow 49	54824-37-2	50	µg/L	n.d.	2	mg/kg	n.d.	Not Detected	Not Detected	-
Disperse Blue 35	12222-75-2, 56524-77-7	50	µg/L	n.d.	2	mg/kg	n.d.	Not Detected	Not Detected	-
Disperse Blue 124	61951-51-7	50	µg/L	n.d.	2	mg/kg	n.d.	Not Detected	Not Detected	-
Disperse Yellow 9	6373-73-5	50	µg/L	n.d.	2	mg/kg	n.d.	Not Detected	Not Detected	-
Disperse Orange 3	730-40-5	50	µg/L	n.d.	2	mg/kg	n.d.	Not Detected	Not Detected	-
Flame Retardants										
Tris(2-chloroethyl) phosphate (TCEP)	115-96-8	5	µg/L	n.d.	1	mg/kg	n.d.	Not Detected	Not Detected	-
Decabromodiphenyl ethers (DecaBDE)	1163-19-5	5	µg/L	n.d.	1	mg/kg	n.d.	Not Detected	Not Detected	-
Tris(2,3-dibromopropyl) phosphate (TRIS)	126-72-7	5	µg/L	n.d.	1	mg/kg	n.d.	Not Detected	Not Detected	-

TEST RESULTS

Factory Name: Bozhou Shanshang Textile Technology Co., Ltd.

Factory Address: No.20 Yaodu Avenue, East District, Shanshan Fashion Industrial Park, Qiaocheng District, Bozhou City, Anhui Province

		Sample ID	52115283381201-01	-	-	52115283381201-02				
		Date of Sampling	08-07-2021	-	-	08-07-2021				
		Sampling Location	Discharged waste water outlet	-	-	Sludge stacking place	Factory Performances (Refer to Remarks in cover page)	*Local Requirements		
		Sampling Start Time	10:20	-	-	10:00				
		Sampling End Time	16:30	-	-	10:10				
		Date of Sample Received	09-07-2021	-	-	09-07-2021				
Items	CAS No.	Reporting Limit	Units	Discharged Waste Water	Reporting Limit	Units	SludgeΦ	Discharged Waste Water	Sludge	Discharged Waste Water
Pentabromodiphenyl ethers (PentaBDE)	32534-81-9	5	µg/L	n.d.	1	mg/kg	n.d.	Not Detected	Not Detected	-
Octabromodiphenyl ethers (OctaBDE)	32536-52-0	5	µg/L	n.d.	1	mg/kg	n.d.	Not Detected	Not Detected	-
Bis(2,3-dibromopropyl)phosphate (BIS)	5412-25-9	5	µg/L	n.d.	1	mg/kg	n.d.	Not Detected	Not Detected	-
Tris(1-aziridinyl)phosphine oxide (TEPA)	545-55-1	5	µg/L	n.d.	1	mg/kg	n.d.	Not Detected	Not Detected	-
Polybrominated biphenyls (PBBs)	59536-65-1	5	µg/L	n.d.	1	mg/kg	n.d.	Not Detected	Not Detected	-
Tetrabromobisphenol A (TBBPA)	79-94-7	5	µg/L	n.d.	1	mg/kg	n.d.	Not Detected	Not Detected	-
Hexabromocyclododecane (HBCDD)	134237-58-6, 134237-51-7, 134237-52-8, 25637-99-4, 3194-55-6	5	µg/L	n.d.	1	mg/kg	n.d.	Not Detected	Not Detected	-
2,2-Bis(bromomethyl)-1,3-propanediol (BBMP)	3296-90-0	5	µg/L	n.d.	1	mg/kg	n.d.	Not Detected	Not Detected	-
Tris(1,3-dichloro-2-propyl)phosphate (TDCPP)	13674-87-8	5	µg/L	n.d.	1	mg/kg	n.d.	Not Detected	Not Detected	-
Short Chain Chlorinated Paraffins (SCCP), C ₁₀ -C ₁₃	85535-84-8	5	µg/L	n.d.	1	mg/kg	n.d.	Not Detected	Not Detected	-
Glycols										
Bis(2-methoxyethyl)-ether	111-96-6	50	µg/L	n.d.	10	mg/kg	n.d.	Not Detected	Not Detected	-
2-Ethoxyethanol	110-80-5	50	µg/L	n.d.	10	mg/kg	n.d.	Not Detected	Not Detected	-
2-Ethoxyethyl acetate	111-15-9	50	µg/L	n.d.	10	mg/kg	n.d.	Not Detected	Not Detected	-
Ethylene glycol dimethyl ether	110-71-4	50	µg/L	n.d.	10	mg/kg	n.d.	Not Detected	Not Detected	-
2-Methoxyethanol	109-86-4	50	µg/L	n.d.	10	mg/kg	n.d.	Not Detected	Not Detected	-
2-Methoxyethylacetate	110-49-6	50	µg/L	n.d.	10	mg/kg	n.d.	Not Detected	Not Detected	-
2-Methoxypropylacetate	70657-70-4	50	µg/L	n.d.	10	mg/kg	n.d.	Not Detected	Not Detected	-
Triethylene glycol dimethyl ether	112-49-2	50	µg/L	n.d.	10	mg/kg	n.d.	Not Detected	Not Detected	-
Halogenated Solvents										
1,2-Dichloroethane	107-06-2	1	µg/L	n.d.	2	mg/kg	n.d.	Not Detected	Not Detected	-
Methylene chloride	75-09-2	1	µg/L	n.d.	2	mg/kg	n.d.	Not Detected	Not Detected	-

TEST RESULTS

Factory Name: Bozhou Shanshang Textile Technology Co., Ltd.

Factory Address: No.20 Yaodu Avenue, East District, Shanshan Fashion Industrial Park, Qiaocheng District, Bozhou City, Anhui Province

Sample ID		52115283381201-01		-	-	52115283381201-02		Factory Performances (Refer to Remarks in cover page)			*Local Requirements
Date of Sampling		08-07-2021		-	-	08-07-2021					
Sampling Location		Discharged waste water outlet		-	-	Sludge stacking place					
Sampling Start Time		10:20		-	-	10:00					
Sampling End Time		16:30		-	-	10:10					
Date of Sample Received		09-07-2021		-	-	09-07-2021					
Items	CAS No.	Reporting Limit	Units	Discharged Waste Water	Reporting Limit	Units	SludgeΦ	Discharged Waste Water	Sludge	Discharged Waste Water	
Trichloroethene	79-01-6	1	µg/L	n.d.	2	mg/kg	n.d.	Not Detected	Not Detected	-	
Tetrachloroethene	127-18-4	1	µg/L	n.d.	2	mg/kg	n.d.	Not Detected	Not Detected	-	
Organotin Compounds											
Mono-, di- and tri-methyltin derivatives	Multiple	0.01	µg/L	n.d.	0.2	mg/kg	n.d.	Not Detected	Not Detected	-	
Monomethyltin (MMT)	Multiple	0.01	µg/L	n.d.	0.2	mg/kg	n.d.	Not Detected	Not Detected	-	
Dimethyltin (DMT)	Multiple	0.01	µg/L	n.d.	0.2	mg/kg	n.d.	Not Detected	Not Detected	-	
Trimethyltin (TMT)	Multiple	0.01	µg/L	n.d.	0.2	mg/kg	n.d.	Not Detected	Not Detected	-	
Mono-, di- and tri-butyltin derivatives	Multiple	0.01	µg/L	n.d.	0.2	mg/kg	n.d.	Not Detected	Not Detected	-	
Monobutyltin (MBT)	1118-46-3, 78763-54-9	0.01	µg/L	n.d.	0.2	mg/kg	n.d.	Not Detected	Not Detected	-	
Dibutyltin (DBT)	1002-53-5	0.01	µg/L	n.d.	0.2	mg/kg	n.d.	Not Detected	Not Detected	-	
Tributyltin (TBT)	56573-85-4	0.01	µg/L	n.d.	0.2	mg/kg	n.d.	Not Detected	Not Detected	-	
Mono-, di- and tri-phenyltin derivatives	Multiple	0.01	µg/L	n.d.	0.2	mg/kg	n.d.	Not Detected	Not Detected	-	
Monophenyltin (MPHT)	Multiple	0.01	µg/L	n.d.	0.2	mg/kg	n.d.	Not Detected	Not Detected	-	
Diphenyltin (DPHT)	Multiple	0.01	µg/L	n.d.	0.2	mg/kg	n.d.	Not Detected	Not Detected	-	
Triphenyltin (TPHT)	892-20-6, 668-34-8	0.01	µg/L	n.d.	0.2	mg/kg	n.d.	Not Detected	Not Detected	-	
Mono-, di- and tri-octyltin derivatives	Multiple	0.01	µg/L	n.d.	0.2	mg/kg	n.d.	Not Detected	Not Detected	-	
Monooctyltin (MOT)	15231-57-9	0.01	µg/L	n.d.	0.2	mg/kg	n.d.	Not Detected	Not Detected	-	
Dioctyltin (DOT)	94410-05-6, 12531-44-4	0.01	µg/L	n.d.	0.2	mg/kg	n.d.	Not Detected	Not Detected	-	
Trioctyltin (TOT)	Multiple	0.01	µg/L	n.d.	0.2	mg/kg	n.d.	Not Detected	Not Detected	-	
Perfluorinated / Polyfluorinated Chemicals (PFCs)											
PFOS	1763-23-1	0.01	µg/L	n.d.	0.10	mg/kg	n.d.	Not Detected	Not Detected	-	
PFOA	335-67-1	0.01	µg/L	n.d.	0.10	mg/kg	n.d.	Not Detected	Not Detected	-	

TEST RESULTS

Factory Name: Bozhou Shanshang Textile Technology Co., Ltd.

Factory Address: No.20 Yaodu Avenue, East District, Shanshan Fashion Industrial Park, Qiaocheng District, Bozhou City, Anhui Province

		Sample ID	52115283381201-01	-	-	52115283381201-02				
		Date of Sampling	08-07-2021	-	-	08-07-2021				
		Sampling Location	Discharged waste water outlet	-	-	Sludge stacking place	Factory Performances (Refer to Remarks in cover page)	*Local Requirements		
		Sampling Start Time	10:20	-	-	10:00				
		Sampling End Time	16:30	-	-	10:10				
		Date of Sample Received	09-07-2021	-	-	09-07-2021				
Items	CAS No.	Reporting Limit	Units	Discharged Waste Water	Reporting Limit	Units	SludgeΦ	Discharged Waste Water	Sludge	Discharged Waste Water
PFBS	375-73-5, 59933-66-3, 29420-49-3, 29420-43-3	0.01	µg/L	n.d.	0.10	mg/kg	n.d.	Not Detected	Not Detected	-
PFHxA	307-24-4	0.01	µg/L	n.d.	0.10	mg/kg	n.d.	Not Detected	Not Detected	-
8:2 FTOH	678-39-7	1	µg/L	n.d.	1	mg/kg	n.d.	Not Detected	Not Detected	-
6:2 FTOH	647-42-7	1	µg/L	n.d.	1	mg/kg	n.d.	Not Detected	Not Detected	-
Phthalates										
Di(2-Ethyl Hexyl) Phthalate (DEHP)	117-81-7	10	µg/L	n.d.	2	mg/kg	n.d.	Not Detected	Not Detected	-
Bis(2-methoxyethyl)phthalate (DMEP)	117-82-8	10	µg/L	n.d.	2	mg/kg	n.d.	Not Detected	Not Detected	-
Di-N-Octyl Phthalate (DNOP)	117-84-0	10	µg/L	n.d.	2	mg/kg	n.d.	Not Detected	Not Detected	-
Di-Iso-Decyl Phthalate (DIDP)	26761-40-0, 68515-49-1	10	µg/L	n.d.	2	mg/kg	n.d.	Not Detected	Not Detected	-
Di-Iso-Nonyl Phthalate (DINP)	28553-12-0, 68515-48-0	10	µg/L	n.d.	2	mg/kg	n.d.	Not Detected	Not Detected	-
Di-N-Hexyl Phthalate (DNHP)	84-75-3	10	µg/L	n.d.	2	mg/kg	n.d.	Not Detected	Not Detected	-
Dibutyl Phthalate (DBP)	84-74-2	10	µg/L	n.d.	2	mg/kg	n.d.	Not Detected	Not Detected	-
Benzyl Butyl Phthalate (BBP)	85-68-7	10	µg/L	n.d.	2	mg/kg	n.d.	Not Detected	Not Detected	-
Dinonyl phthalate (DNP)	84-76-4	10	µg/L	n.d.	2	mg/kg	n.d.	Not Detected	Not Detected	-
Diethyl Phthalate (DEP)	84-66-2	10	µg/L	n.d.	2	mg/kg	n.d.	Not Detected	Not Detected	-
Di-N-Propyl Phthalate (DPRP)	131-16-8	10	µg/L	n.d.	2	mg/kg	n.d.	Not Detected	Not Detected	-
Di-Iso-Butyl Phthalate (DIBP)	84-69-5	10	µg/L	n.d.	2	mg/kg	n.d.	Not Detected	Not Detected	-
Dicyclohexyl Phthalate (DCHP)	84-61-7	10	µg/L	n.d.	2	mg/kg	n.d.	Not Detected	Not Detected	-
Di-Iso-Octyl Phthalate (DIOP)	27554-26-3	10	µg/L	n.d.	2	mg/kg	n.d.	Not Detected	Not Detected	-
1,2-Benzenedicarboxylic acid, Di-C7-11 Branched and Linear Alkyl Esters (DHNUP)	68515-42-4	10	µg/L	n.d.	2	mg/kg	n.d.	Not Detected	Not Detected	-
1,2-Benzenedicarboxylic acid, Di-C6-8 Branched Alkyl Esters, C7-rich (DIHP)	71888-89-6	10	µg/L	n.d.	2	mg/kg	n.d.	Not Detected	Not Detected	-
Polycyclic Aromatic Hydrocarbons (PAHs)										

TEST RESULTS

Factory Name: Bozhou Shanshang Textile Technology Co., Ltd.

Factory Address: No.20 Yaodu Avenue, East District, Shanshan Fashion Industrial Park, Qiaocheng District, Bozhou City, Anhui Province

Sample ID		52115283381201-01	-	-	52115283381201-02	Factory Performances (Refer to Remarks in cover page)		*Local Requirements		
Date of Sampling		08-07-2021	-	-	08-07-2021					
Sampling Location		Discharged waste water outlet	-	-	Sludge stacking place					
Sampling Start Time		10:20	-	-	10:00					
Sampling End Time		16:30	-	-	10:10					
Date of Sample Received		09-07-2021	-	-	09-07-2021					
Items	CAS No.	Reporting Limit	Units	Discharged Waste Water	Reporting Limit	Units	Sludge Φ	Discharged Waste Water	Sludge	Discharged Waste Water
Bezo[a]pyrene	50-32-8	1	$\mu\text{g/L}$	n.d.	0.2	mg/kg	n.d.	Not Detected	Not Detected	-
Anthracene	120-12-7	1	$\mu\text{g/L}$	n.d.	0.2	mg/kg	n.d.	Not Detected	Not Detected	-
Pyrene	129-00-0	1	$\mu\text{g/L}$	n.d.	0.2	mg/kg	n.d.	Not Detected	Not Detected	-
Benzo[ghi]perylene	191-24-2	1	$\mu\text{g/L}$	n.d.	0.2	mg/kg	n.d.	Not Detected	Not Detected	-
Benzo[e]pyrene	192-97-2	1	$\mu\text{g/L}$	n.d.	0.2	mg/kg	n.d.	Not Detected	Not Detected	-
Indeno[1,2,3-cd]pyrene	193-39-5	1	$\mu\text{g/L}$	n.d.	0.2	mg/kg	n.d.	Not Detected	Not Detected	-
Benzo[j]fluoranthene	205-82-3	1	$\mu\text{g/L}$	n.d.	0.2	mg/kg	n.d.	Not Detected	Not Detected	-
Benzo[b]fluoranthene	205-99-2	1	$\mu\text{g/L}$	n.d.	0.2	mg/kg	n.d.	Not Detected	Not Detected	-
Fluoranthene	206-44-0	1	$\mu\text{g/L}$	n.d.	0.2	mg/kg	n.d.	Not Detected	Not Detected	-
Benzo[k]fluoranthene	207-08-9	1	$\mu\text{g/L}$	n.d.	0.2	mg/kg	n.d.	Not Detected	Not Detected	-
Acenaphthylene	208-96-8	1	$\mu\text{g/L}$	n.d.	0.2	mg/kg	n.d.	Not Detected	Not Detected	-
Chrysene	218-01-9	1	$\mu\text{g/L}$	n.d.	0.2	mg/kg	n.d.	Not Detected	Not Detected	-
Dibenz[a,h]anthracene	53-70-3	1	$\mu\text{g/L}$	n.d.	0.2	mg/kg	n.d.	Not Detected	Not Detected	-
Benzo[a]anthracene	56-55-3	1	$\mu\text{g/L}$	n.d.	0.2	mg/kg	n.d.	Not Detected	Not Detected	-
Acenaphthene	83-32-9	1	$\mu\text{g/L}$	n.d.	0.2	mg/kg	n.d.	Not Detected	Not Detected	-
Phenanthrene	85-01-8	1	$\mu\text{g/L}$	n.d.	0.2	mg/kg	n.d.	Not Detected	Not Detected	-
Fluorene	86-73-7	1	$\mu\text{g/L}$	n.d.	0.2	mg/kg	n.d.	Not Detected	Not Detected	-
Naphthalene	91-20-3	1	$\mu\text{g/L}$	n.d.	0.2	mg/kg	n.d.	Not Detected	Not Detected	-
Volatile Organic Compounds (VOCs)										
Benzene	71-43-2	1	$\mu\text{g/L}$	n.d.	2	mg/kg	n.d.	Not Detected	Not Detected	-
Xylene	1330-20-7	1	$\mu\text{g/L}$	n.d.	2	mg/kg	n.d.	Not Detected	Not Detected	-
o-cresol	95-48-7	1	$\mu\text{g/L}$	n.d.	2	mg/kg	n.d.	Not Detected	Not Detected	-

TEST RESULTS

Factory Name: Bozhou Shanshang Textile Technology Co., Ltd.

Factory Address: No.20 Yaodu Avenue, East District, Shanshan Fashion Industrial Park, Qiaocheng District, Bozhou City, Anhui Province

Sample ID		52115283381201-01	-	-	52115283381201-02	Factory Performances (Refer to Remarks in cover page)		*Local Requirements		
Date of Sampling		08-07-2021	-	-	08-07-2021					
Sampling Location		Discharged waste water outlet	-	-	Sludge stacking place					
Sampling Start Time		10:20	-	-	10:00					
Sampling End Time		16:30	-	-	10:10					
Date of Sample Received		09-07-2021	-	-	09-07-2021					
Items	CAS No.	Reporting Limit	Units	Discharged Waste Water	Reporting Limit	Units	Sludge Φ	Discharged Waste Water	Sludge	Discharged Waste Water
p-cresol	106-44-5	1	$\mu\text{g/L}$	n.d.	2	mg/kg	n.d.	Not Detected	Not Detected	-
m-cresol	108-39-4	1	$\mu\text{g/L}$	n.d.	2	mg/kg	n.d.	Not Detected	Not Detected	-
Additional Parameters										
Dry Mass (Total Solids)	-	-	-	-	-	%	12.5	-	-	-

Remarks:

*n.d." = Not Detected

*N/A" = Not Tested

*- = Not Required to be Test

^The test result is based on the calculation of selected element(s) and to the worst-case scenario

Φ Sludge results are reported based on dry mass

#Data collection only for polyester production

*No local wastewater discharge requirement could be provided by the factory

**Data provided by factory(online monitor system)

Δ Due to inaccessible of the location of Receiving Water, the measurement of Temp-Receiving Water cannot be determined

1) LOR values have been adjusted accordingly due to matrix interference

TEST PARAMETERS

Factory Name: Bozhou Shanshang Textile Technology Co., Ltd.

Factory Address: No.20 Yaodu Avenue, East District, Shanshan Fashion Industrial Park, Qiaocheng District, Bozhou City, Anhui Province

ITEMS	CAS No.	METHODS	ZDHC REQUIREMENTS			Units
			Foundational Limit	Progressive Limit	Aspirational Limit	
Conventional Parameters						
Temperature	-	USEPA 170.1 or GB/T 13195	Δ15 or max. 35	Δ10 or max. 30	Δ5 or max. 25	°C
TSS	-	USEPA 160.2, APHA 2540D, ISO 11923 or GB/T 11901	50	15	5	mg/L
COD	-	USEPA 410.4, APHA 5220D, ISO 6060 or HJ 828	150	80	40	mg/L
Total Nitrogen (Total-N)	-	USEPA 351.2, APHA 4500P-J, APHA 4500N-C, ISO 5663, ISO 29441, HJ 636 or GB 11891	20	10	5	mg/L
pH Value	-	USEPA 150.1, APHA 4500-H+, ISO 10523 or GB/T 6920	6-9	6-9	6-9	-
Colour (436nm; 525nm; 620nm)	-	ISO 7887 (Method B)	7; 5; 3	5; 3; 2	2; 1; 1	m ⁻¹
BOD (5-day)	-	USEPA 405.1, APHA 5210B, ISO 5815-1, EN 1899-1 or HJ 505	30	15	5	mg/L
Ammonium Nitrogen (Ammonium-N)	-	USEPA 350.1, APHA 4500NH ₃ -N, ISO 7150, ISO 11732, HJ 535 or HJ 536	10	1	0.5	mg/L
Total Phosphorus (Total-P)	-	USEPA 365.4, APHA 4500P-J, ISO 6878, ISO 11885 or GB/T 11893	3	0.5	0.1	mg/L
AOX	-	USEPA 1650, ISO 9562, EN ISO 9563 or HJ/T 83-2001	5	1	0.1	mg/L
Oil and Grease	-	USEPA 1664, ISO 9377-2 or HJ 637	10	2	0.5	mg/L
Phenol	-	APHA 5530 B, C & D, ISO 14402 or HJ 503	0.5	0.01	0.001	mg/L
Coliform	-	USEPA 9132, ISO 9308-1 or GB/T 5750.12	400	100	25	Bacteria / 100ml
Persistent Foam	-	N/A	Not visible	Not visible	Not visible	-
Anions						
Cyanide	-	Waste water: USEPA 335.2, APHA 4500-CN, ISO 6703-1,-2,-3, ISO 14403-1,-2 or HJ 484 Sludge: With reference to USEPA 9013, USEPA 9014, USEPA 9213, ISO 11262, HJ 745 or CN converted to HCN by reflux-distillation to NaOH followed by colourimetry or ISE	0.2	0.1	0.05	mg/L
Sulfide	-	APHA 4500-S2-D, ISO 10530 or GB/T 16489	0.5	0.05	0.01	mg/L
Sulfite	-	USEPA 377.1, ISO10304-3 or HJ 84	2	0.5	0.2	mg/L
Metals						
Total Antimony (Sb)	7440-36-0		0.1	0.05	0.01	mg/L
Total Chromium (Cr)	7440-47-3		0.2	0.1	0.05	mg/L
Total Cobalt (Co)	7440-48-4		0.05	0.02	0.01	mg/L
Total Copper (Cu)	7440-50-8	Waste water: With reference to USEPA 200.7, USEPA 200.8, USEPA 6010C, USEPA 6020A, ISO 11885, ISO 12846, ISO 17852, ISO 18412, GB 7466, GB 7467, GB 7472, GB 7475, GB 11907, HJ 597, HJ 700 or acid digestion	1	0.5	0.25	mg/L
Total Nickel (Ni)	7440-02-0	followed by ICP or ICP/MS analysis	0.2	0.1	0.05	mg/L
Total Silver (Ag)	7440-22-4	Sludge: With reference to USEPA 3050, USEPA 3051A, USEPA 3060A, USEPA 6010D, USEPA 6020B, USEPA 7471B or acid/peroxide digestion	0.1	0.05	0.005	mg/L
Total Zinc (Zn)	7440-66-6	followed by ICP or ICP/MS analysis	5.0	1.0	0.5	mg/L
Total Arsenic (As)	7440-38-2		0.05	0.01	0.005	mg/L
Total Cadmium (Cd)	7440-43-9		0.1	0.05	0.01	mg/L

TEST PARAMETERS

Factory Name: Bozhou Shanshang Textile Technology Co., Ltd.

Factory Address: No.20 Yaodu Avenue, East District, Shanshan Fashion Industrial Park, Qiaocheng District, Bozhou City, Anhui Province

ITEMS	CAS No.	METHODS	ZDHC REQUIREMENTS			Units
			Foundational Limit	Progressive Limit	Aspirational Limit	
Hexavalent Chromium (Cr-VI)	7440-47-3, 18540-29-9	Waste water: With reference to USEPA 218.6, ISO 18412, GB 7467 or solvent extraction and derivatisation followed by UV/VIS analysis Sludge: With reference to USEPA 7196, USEPA 7199 or alkaline digestion followed by colourimetric UV/VIS or colourimetric IC analysis	0.05	0.005	0.001	mg/L
Total Lead (Pb)	7439-92-1	Waste water: With reference to USEPA 200.7, USEPA 200.8, USEPA 6010C, USEPA 6020A, ISO 11885, ISO 12846, ISO 17852, ISO 18412, GB 7466, GB 7467, GB 7472, GB 7475, GB 11907, HJ 597, HJ 700 or acid digestion followed by ICP or ICP/MS analysis Sludge: With reference to USEPA 3050, USEPA 3051A, USEPA 3060A, USEPA 6010D, USEPA 6020B, USEPA 7471B or acid/peroxide digestion followed by CVAA, ICP or ICP/MS analysis	0.1	0.05	0.01	mg/L
Total Mercury (Hg)	7439-97-6	Waste water: With reference to USEPA 218.6, ISO 18412, GB 7467 or solvent extraction and derivatisation followed by UV/VIS analysis Sludge: With reference to USEPA 7196, USEPA 7199 or alkaline digestion followed by colourimetric UV/VIS or colourimetric IC analysis	0.01	0.005	0.001	mg/L
Alkylphenols (APs) and Alkylphenol Ethoxylates (APEOs)						
NP / OP		Waste water: With reference to ISO 18857-2 or ASTM D7065 followed by GC/MS or LC/MS(-MS) analysis Sludge: With reference to USEPA 3540/3541, USEPA 3550, USEPA 3560, ISO 18857-2 or ASTM D7065 followed by GC/MS or LC/MS analysis			-	
NPEO / OPEO		Waste water: With reference to ISO 18254-1, ISO 18857-2 or ASTM D7065 followed by GC/MS or LC/MS analysis Sludge: With reference to ISO 18254-1, ISO 18857-2 or ASTM D7065 followed by GC/MS or LC/MS analysis			-	
Chlorobenzenes and Chlorotoluenes (COCs)						
		Waste water: With reference to USEPA 8260B, USEPA 8270D or solvent extraction followed by GC/MS analysis Sludge: With reference to USEPA 3540/3541, USEPA 3550, USEPA 3560, USEPA 3650, USEPA 8270 or solvent extraction followed by GC/MS analysis			-	
Chlorophenols						
		Waste water: With reference to USEPA 8270D, ISO 14154 or solvent extraction and derivatisation with KOH, acetic anhydride followed by GC/MS analysis Sludge: With reference to ISO 14154, acid/base liquid extraction, acetylation or liquid/liquid extraction followed by GC/MS analysis			-	
Azo Dyes						
		Waste water: With reference to USEPA 8270D, EN 14362-1, EN 14362-3 or solvent extraction with sodium dithionite reduction followed by GC/MS or LC/MS analysis Sludge: With reference to ISO 14362-1, ISO 14362-3 or solvent extraction with sodium dithionite reduction followed by GC/MS or LC/MS analysis			-	
Carcinogenic Dyes						
		Waste water: Solvent extraction followed by LC/MS analysis Sludge: With reference to ISO 16373 or solvent extraction followed by LC/MS analysis			-	

TEST PARAMETERS

Factory Name: Bozhou Shanshang Textile Technology Co., Ltd.

Factory Address: No.20 Yaodu Avenue, East District, Shanshan Fashion Industrial Park, Qiaocheng District, Bozhou City, Anhui Province

ITEMS	CAS No.	METHODS	ZDHC REQUIREMENTS			Units
			Foundational Limit	Progressive Limit	Aspirational Limit	
Disperse Dyes		Waste water: Solvent extraction followed by LC/MS analysis Sludge: With reference to ISO 16373 or solvent extraction followed by LC/MS analysis		-		
Flame Retardants		Waste water: With reference to USEPA 527, USEPA 8270, USEPA 8321B, ISO 22032 or solvent extraction followed by GC/MS or LC/MS analysis Sludge: With reference to ISO 22032 or solvent extraction followed by GC/MS or LC/MS analysis		-		
Glycols		Waste water: With reference to USEPA 8270 or solvent extraction followed by GC/MS or LC/MS analysis Sludge: With reference to USEPA 8270D, ISO 22892 or solvent extraction followed by GC/MS or LC/MS analysis		-		
Halogenated Solvents		Waste water: With reference to USEPA 8260B, Purge-and-Trap, Headspace or solvent extraction followed by GC/MS analysis Sludge: With reference to USEPA 5035, USEPA 50211, USEPA 8010 or solvent extraction followed by GC/MS analysis		-		
Organotin Compounds		Waste water: With reference to ISO 17353 and derivatisation with sodium diethyl dithiocarbamate followed by GC/MS analysis Sludge: With reference to ISO 23161 and derivatisation with sodium diethyl dithiocarbamate followed by GC/MS analysis		-		
Perfluorinated / Polyfluorinated Chemicals (PFCs)		Waste water: With reference to DIN38407-42 or CEN/TS 15968 and derivatisation with acetic anhydride followed by GC/MS analysis Sludge: With reference to DIN38407-42 and derivatisation with acetic anhydride followed by GC/MS analysis Waste water: With reference to DIN38407-42 or CEN/TS 15968 followed by LCMS or LC/MS(-MS) analysis Sludge: With reference to DIN38407-42 followed by LCMS or LC/MS(-MS) analysis		-		
FTOHs (Non-ionic)						
Others (Ionic)						
Phthalates		Waste water: With reference to USEPA 8270D, ISO 18856 or solvent extraction followed by GC/MS analysis Sludge: With reference to USEPA 3540/3541, USEPA 3550, USEPA 3560, ISO 18856 or solvent extraction followed by GC/MS analysis		-		



TEST PARAMETERS

Factory Name: Bozhou Shanshang Textile Technology Co., Ltd.

Factory Address: No.20 Yaodu Avenue, East District, Shanshan Fashion Industrial Park, Qiaocheng District, Bozhou City, Anhui Province

ITEMS	CAS No.	METHODS	ZDHC REQUIREMENTS			Units
			Foundational Limit	Progressive Limit	Aspirational Limit	
Polycyclic Aromatic Hydrocarbons (PAHs)		Waste water: With reference to USEPA 8270, DIN 38407-39 or solvent extraction followed by GC/MS analysis Sludge: With reference to USEPA 3540/3541, USEPA 3550, USEPA 3560, USEPA 3650, USEPA 8270 or solvent extraction followed by GC/MS analysis		-		
Volatile Organic Compounds (VOCs)		Waste water: With reference to USEPA 8260B, Purge-and-Trap, Headspace or solvent extraction followed by GC/MS analysis Sludge: With reference to USEPA 5035, USEPA 5021, USEPA 8260, DIN 38407 Part 43 or solvent extraction followed by GC/MS analysis		-		

PIPING PLAN

Factory Name: Bozhou Shanshan Textile Technology Co., Ltd.
Factory Address: No.20 Yaodu Avenue, East District, Shanshan Fashion Industrial Park,
Qiaocheng District, Bozhou City, Anhui Province

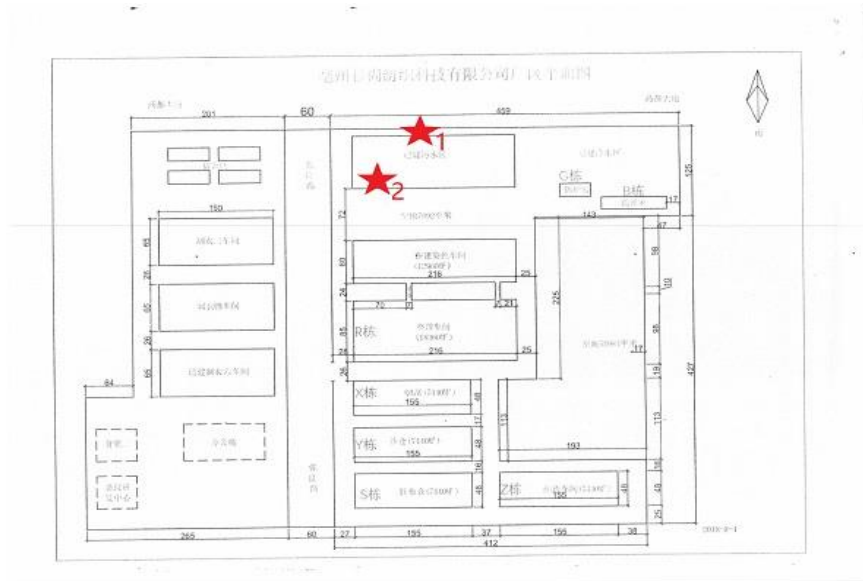

Remark:
1. Discharged Waste Water
2. Sludge

SAMPLING PHOTOS

Factory Name: Bozhou Shanshang Textile Technology Co., Ltd.
Factory Address: No.20 Yaodu Avenue, East District, Shanshan Fashion Industrial Park, Qiaocheng District, Bozhou City, Anhui Province



SAMPLING PHOTOS

Factory Name: Bozhou Shanshang Textile Technology Co., Ltd.
Factory Address: No.20 Yaodu Avenue, East District, Shanshan Fashion Industrial Park, Qiaocheng District, Bozhou City, Anhui Province

Sludge

GPS Data: 33°50'30" N, 115°43'32" E

SAMPLING LOCATION, CLOSE-UP VIEW



SAMPLING LOCATION, FAR VIEW



***** END OF REPORT *****