

TEST REPORT

CLIENT DETAILS

Client Name: ERO Dying
Client Contact: Giri Dhari Prasad
Telephone: +91 9943017000
Email: yarndyeing@eromills.com
Address: 250/6, Javuli Nagar, R.N. Pudur, Erode, 638005

LABORATORY DETAILS

SGS Affiliate: SGS India Pvt Ltd., Chennai
SGS Contact: Balla Suresh Kumar
Telephone: +91 9840830472
Email: balla.sureshkumar@sgs.com
Address: 28 B/1(SP), 28B/2 (SP), Second Main Road, Ambattur Ind. Est., Ambattur, Chennai-58.

FACTORY DETAILS

Factory Name: ERO Dying
Factory Contact: Prasad
Telephone: +91 9943029000
Email: yarndyeing@eromills.com
Address: 250/6, Javuli Nagar, R.N. Pudur, Erode, 638005
Discharge Destination Zero-Liquid Discharge Treatment
Types of Mills: (4) Fabric Dyeing, Finishing, Printing

SAMPLE AND TESTING DETAILS

Sampling Country: SGS India Pvt. Ltd.,
Sampling Engineer: K.Manoj Prabakar (8F146507480)
Sampling Date: 14-09-2021
Sample Received Date: 15-09-2021
Test Performing Period: 15-09-2021 - 29-09-2021
No. of Samples: Water (1); Sludge (1)
Sample Descriptions: 1) Raw Wastewater (6-hour Composite)
 2) Sludge (Grab)
Sample Volume 8L Water sample; 1 Kg Sludge
Testing Institute: SGS India Pvt. Ltd., Chennai CRS Lab / Multilab
Discharge Method: Zero-Liquid Discharge

OVERALL RESULTS

	Raw Waste Water	Sludge
Anions / Metals:	Fulfill Aspirational Limit	Detected
MRSL Parameters:	Not Detected	Not Detected

REMARKS

1. This test document cannot be reproduced in any way, except in full content, without prior approval in writing by the laboratory.
2. The results shown in this test report refer only to the sampling and the sample(s) tested unless otherwise stated.

Per pro SGS India Private Ltd

**P.SHANMUGAM
EXECUTIVE**
Email your Test Report Related Enquiries at Feedback.SLT@sgs.com
JOE No. : 2142818939
Control No: 1242539734

RESULT SUMMARY

Factory Name: ERO Dying
 Factory Address: 250/6, Javuli Nagar, R.N. Pudur, Erode,
 638005

TEST ITEMS	Raw Waste Water	Sludge
Anions	-	O
Metals	O	X
Alkylphenols (APs) and Alkylphenol Ethoxylates (APEOs)	O	O
Chlorobenzenes and Chlorotoluenes (COCs)	O	O
Chlorophenols	O	O
Azo dyes	O	O
Carcinogenic dyes	O	O
Disperse dyes	O	O
Flame retardants	O	O
Glycols	O	O
Halogenated solvents	O	O
Organotin Compounds	O	O
Perfluorinated / Polyfluorinated Chemicals (PFCs)	O	O
Phthalates	O	O
Polycyclic Aromatic Hydrocarbons (PAHs)	O	O
Volatile Organic Compounds (VOCs)	O	O

Note:

X - Detected

O - Not Detected

N/A - Not Tested

This document is issued by the Company under its General Conditions of Service printed overleaf or available on request and accessible at http://www.sgs.com/terms_and_conditions.htm and and Terms and Conditions for electronic documents www.sgs.com/terms_e-document.htm. Attention is drawn to the limitation of liability, indemnification and jurisdiction issues defined therein. Any holder of this document is advised that information contained hereon reflects the Company's findings at the time of its intervention only and within the limits of Client's instructions, if any. The Company's sole responsibility is to its Client and this document does not exonerate parties to a transaction from exercising all their rights and obligations under the transaction documents. Any unauthorized alteration, forgery or falsification of the content or appearance of this document is unlawful and offenders may be prosecuted to the fullest extent of the law. Unless otherwise stated the results shown in this test report refer only to the sample(s) tested and such sample(s) are retained for 30 days only. This document cannot be reproduced except in full, without prior approval of the Company.

TEST RESULTS

Factory Name: ERO Dying

Factory Address: 250/6, Javuli Nagar, R.N. Pudur, Erode, 638005

		Sample ID	1242035186 (A)	-	-	1242035186 (B)	Factory Performances		
		Date of Sampling	14.09.2021	-	-	14.09.2021			
		Sampling Location	Waste Water Before Treatment - Collection Tank	-	-	Sludge - Storage bed			
		Sampling Start Time	10:00	-	-	15:30			
		Sampling End Time	16:00	-	-	15:45			
		Date of Sample Received	15.09.2021	-	-	15.09.2021			
Items	CAS No.	Reporting Limit	Units	Raw Waste Water	Reporting Limit	Units	SludgeΦ	Raw Waste Water	Sludge
Sample Colour Description	-	-	-	Green	-	-	Brown	-	-
Anions									
Cyanide	-	0.05	mg/L	-	1	mg/kg	n.d.	-	Not Detected
Metals									
Total Antimony (Sb)	7440-36-0	0.01	mg/L	n.d.	-	-	-	Fulfill Aspirational Limit	-
Total Chromium (Cr)	7440-47-3	0.05	mg/L	n.d.	-	-	-	Fulfill Aspirational Limit	-
Total Cobalt (Co)	7440-48-4	0.01	mg/L	n.d.	-	-	-	Fulfill Aspirational Limit	-
Total Copper (Cu)	7440-50-8	0.25	mg/L	n.d.	-	-	-	Fulfill Aspirational Limit	-
Total Nickel (Ni)	7440-02-0	0.05	mg/L	n.d.	-	-	-	Fulfill Aspirational Limit	-
Total Silver (Ag)	7440-22-4	0.005	mg/L	n.d.	-	-	-	Fulfill Aspirational Limit	-
Total Zinc (Zn)	7440-66-6	0.5	mg/L	n.d.	-	-	-	Fulfill Aspirational Limit	-
Total Arsenic (As)	7440-38-2	0.005	mg/L	n.d.	2	mg/kg	n.d.	Fulfill Aspirational Limit	Not Detected
Total Cadmium (Cd)	7440-43-9	0.01	mg/L	n.d.	2	mg/kg	n.d.	Fulfill Aspirational Limit	Not Detected
Hexavalent Chromium (Cr-VI)	7440-47-3, 18540-29-9	0.001	mg/L	n.d.	2	mg/kg	n.d.	Fulfill Aspirational Limit	Not Detected
Total Lead (Pb)	7439-92-1	0.01	mg/L	n.d.	2	mg/kg	42	Fulfill Aspirational Limit	Detected
Total Mercury (Hg)	7439-97-6	0.001	mg/L	n.d.	0.2	mg/kg	n.d.	Fulfill Aspirational Limit	Not Detected
Alkylphenols (APs) & Alkylphenol Ethoxylates (APEOs)									
Nonylphenol (NP), mixed isomers	Multiple, including 104-40-5, 11066-49-2, 25154-52-3, 84852-15-3, 90481-04-2, 1173019-62-9	5	µg/L	n.d.	0.4	mg/kg	n.d.	Not Detected	Not Detected
Octylphenol (OP), mixed isomers	Multiple, including 140-66-9, 1806-26-4, 27193-28-8	5	µg/L	n.d.	0.4	mg/kg	n.d.	Not Detected	Not Detected
Octylphenol ethoxylates (OPEO)	Multiple, including 9002-93-1, 9036-19-5, 68987-90-6	5	µg/L	n.d.	0.4	mg/kg	n.d.	Not Detected	Not Detected
Nonylphenol ethoxylates (NPEO)	Multiple, including 9016-45-9, 26027-38-3, 37205-87-1, 68412-54-4, 127087-87-0	5	µg/L	n.d.	0.4	mg/kg	n.d.	Not Detected	Not Detected
Chlorobenzenes & Chlorotoluenes (COCs)									
Monochlorobenzenes	108-90-7	0.2	µg/L	n.d.	0.2	mg/kg	n.d.	Not Detected	Not Detected
1,2-Dichlorobenzene	95-50-1	0.2	µg/L	n.d.	0.2	mg/kg	n.d.	Not Detected	Not Detected
1,3-Dichlorobenzene	541-73-1	0.2	µg/L	n.d.	0.2	mg/kg	n.d.	Not Detected	Not Detected

This document is issued by the Company under its General Conditions of Service printed overleaf or available on request and accessible at http://www.sgs.com/terms_and_conditions.htm and and Terms and Conditions for electronic documents www.sgs.com/terms_e-document.htm. Attention is drawn to the limitation of liability, indemnification and jurisdiction issues defined therein. Any holder of this document is advised that information contained hereon reflects the Company's findings at the time of its intervention only and within the limits of Client's instructions, if any. The Company's sole responsibility is to its Client and this document does not exonerate parties to a transaction from exercising all their rights and obligations under the transaction documents. Any unauthorized alteration, forgery or falsification of the content or appearance of this document is unlawful and offenders may be prosecuted to the fullest extent of the law. Unless otherwise stated the results shown in this test report refer only to the sample(s) tested and such sample(s) are retained for 30 days only. This document cannot be reproduced except in full, without prior approval of the Company.

TEST RESULTS

Factory Name: ERO Dying

Factory Address: 250/6, Javuli Nagar, R.N. Pudur, Erode, 638005

		Sample ID	1242035186 (A)	-	-	1242035186 (B)	Factory Performances		
		Date of Sampling	14.09.2021	-	-	14.09.2021			
		Sampling Location	Waste Water Before Treatment - Collection Tank	-	-	Sludge - Storage bed			
		Sampling Start Time	10:00	-	-	15:30			
		Sampling End Time	16:00	-	-	15:45			
		Date of Sample Received	15.09.2021	-	-	15.09.2021			
Items	CAS No.	Reporting Limit	Units	Raw Waste Water	Reporting Limit	Units	SludgeΦ	Raw Waste Water	Sludge
1,4-Dichlorobenzene	106-46-7	0.2	µg/L	n.d.	0.2	mg/kg	n.d.	Not Detected	Not Detected
1,2,3-Trichlorobenzene	87-61-6	0.2	µg/L	n.d.	0.2	mg/kg	n.d.	Not Detected	Not Detected
1,2,4-Trichlorobenzene	120-82-1	0.2	µg/L	n.d.	0.2	mg/kg	n.d.	Not Detected	Not Detected
1,3,5-Trichlorobenzene	108-70-3	0.2	µg/L	n.d.	0.2	mg/kg	n.d.	Not Detected	Not Detected
1,2,3,4-Tetrachlorobenzene	634-66-2	0.2	µg/L	n.d.	0.2	mg/kg	n.d.	Not Detected	Not Detected
1,2,3,5-Tetrachlorobenzene	634-90-2	0.2	µg/L	n.d.	0.2	mg/kg	n.d.	Not Detected	Not Detected
1,2,4,5-Tetrachlorobenzene	95-94-3	0.2	µg/L	n.d.	0.2	mg/kg	n.d.	Not Detected	Not Detected
Pentachlorobenzene	608-93-5	0.2	µg/L	n.d.	0.2	mg/kg	n.d.	Not Detected	Not Detected
Hexachlorobenzene	118-74-1	0.2	µg/L	n.d.	0.2	mg/kg	n.d.	Not Detected	Not Detected
2-Chlorotoluene	95-49-8	0.2	µg/L	n.d.	0.2	mg/kg	n.d.	Not Detected	Not Detected
3-Chlorotoluene	108-41-8	0.2	µg/L	n.d.	0.2	mg/kg	n.d.	Not Detected	Not Detected
4-Chlorotoluene	106-43-4	0.2	µg/L	n.d.	0.2	mg/kg	n.d.	Not Detected	Not Detected
2,3-Dichlorotoluene	32768-54-0	0.2	µg/L	n.d.	0.2	mg/kg	n.d.	Not Detected	Not Detected
2,4-Dichlorotoluene	95-73-8	0.2	µg/L	n.d.	0.2	mg/kg	n.d.	Not Detected	Not Detected
2,5-Dichlorotoluene	19398-61-9	0.2	µg/L	n.d.	0.2	mg/kg	n.d.	Not Detected	Not Detected
2,6-Dichlorotoluene	118-69-4	0.2	µg/L	n.d.	0.2	mg/kg	n.d.	Not Detected	Not Detected
3,4-Dichlorotoluene	95-75-0	0.2	µg/L	n.d.	0.2	mg/kg	n.d.	Not Detected	Not Detected
3,5-Dichlorotoluene	25186-47-4	0.2	µg/L	n.d.	0.2	mg/kg	n.d.	Not Detected	Not Detected
2,3,4-Trichlorotoluene	7359-72-0	0.2	µg/L	n.d.	0.2	mg/kg	n.d.	Not Detected	Not Detected
2,3,6-Trichlorotoluene	2077-46-5	0.2	µg/L	n.d.	0.2	mg/kg	n.d.	Not Detected	Not Detected
2,4,5-Trichlorotoluene	6639-30-1	0.2	µg/L	n.d.	0.2	mg/kg	n.d.	Not Detected	Not Detected
2,4,6-Trichlorotoluene	23749-65-7	0.2	µg/L	n.d.	0.2	mg/kg	n.d.	Not Detected	Not Detected
3,4,5-Trichlorotoluene	21472-86-6	0.2	µg/L	n.d.	0.2	mg/kg	n.d.	Not Detected	Not Detected

This document is issued by the Company under its General Conditions of Service printed overleaf or available on request and accessible at http://www.sgs.com/terms_and_conditions.htm and Terms and Conditions for electronic documents www.sgs.com/terms_e-document.htm. Attention is drawn to the limitation of liability, indemnification and jurisdiction issues defined therein. Any holder of this document is advised that information contained hereon reflects the Company's findings at the time of its intervention only and within the limits of Client's instructions, if any. The Company's sole responsibility is to its Client and this document does not exonerate parties to a transaction from exercising all their rights and obligations under the transaction documents. Any unauthorized alteration, forgery or falsification of the content or appearance of this document is unlawful and offenders may be prosecuted to the fullest extent of the law. Unless otherwise stated the results shown in this test report refer only to the sample(s) tested and such sample(s) are retained for 30 days only. This document cannot be reproduced except in full, without prior approval of the Company.

TEST RESULTS

Factory Name: ERO Dying

Factory Address: 250/6, Javuli Nagar, R.N. Pudur, Erode, 638005

		Sample ID	1242035186 (A)	-	-	1242035186 (B)	Factory Performances		
		Date of Sampling	14.09.2021	-	-	14.09.2021			
		Sampling Location	Waste Water Before Treatment - Collection Tank	-	-	Sludge - Storage bed			
		Sampling Start Time	10:00	-	-	15:30			
		Sampling End Time	16:00	-	-	15:45			
		Date of Sample Received	15.09.2021	-	-	15.09.2021			
Items	CAS No.	Reporting Limit	Units	Raw Waste Water	Reporting Limit	Units	SludgeΦ	Raw Waste Water	Sludge
2,3,4,5-Tetrachlorotoluene	76057-12-0	0.2	µg/L	n.d.	0.2	mg/kg	n.d.	Not Detected	Not Detected
2,3,5,6-Tetrachlorotoluene	29733-70-8	0.2	µg/L	n.d.	0.2	mg/kg	n.d.	Not Detected	Not Detected
2,3,4,6-Tetrachlorotoluene	875-40-1	0.2	µg/L	n.d.	0.2	mg/kg	n.d.	Not Detected	Not Detected
Pentachlorotoluene	877-11-2	0.2	µg/L	n.d.	0.2	mg/kg	n.d.	Not Detected	Not Detected
Chlorophenols									
2-Chlorophenol	95-57-8	0.5	µg/L	n.d.	0.05	mg/kg	n.d.	Not Detected	Not Detected
3-Chlorophenol	108-43-0	0.5	µg/L	n.d.	0.05	mg/kg	n.d.	Not Detected	Not Detected
4-Chlorophenol	106-48-9	0.5	µg/L	n.d.	0.05	mg/kg	n.d.	Not Detected	Not Detected
2,3-Dichlorophenol	576-24-9	0.5	µg/L	n.d.	0.05	mg/kg	n.d.	Not Detected	Not Detected
2,4-Dichlorophenol	120-83-2	0.5	µg/L	n.d.	0.05	mg/kg	n.d.	Not Detected	Not Detected
2,5-Dichlorophenol	583-78-8	0.5	µg/L	n.d.	0.05	mg/kg	n.d.	Not Detected	Not Detected
2,6-Dichlorophenol	87-65-0	0.5	µg/L	n.d.	0.05	mg/kg	n.d.	Not Detected	Not Detected
3,4-Dichlorophenol	95-77-2	0.5	µg/L	n.d.	0.05	mg/kg	n.d.	Not Detected	Not Detected
3,5-Dichlorophenol	591-35-5	0.5	µg/L	n.d.	0.05	mg/kg	n.d.	Not Detected	Not Detected
2,3,4-Trichlorophenol	15950-66-0	0.5	µg/L	n.d.	0.05	mg/kg	n.d.	Not Detected	Not Detected
2,3,5-Trichlorophenol	933-78-8	0.5	µg/L	n.d.	0.05	mg/kg	n.d.	Not Detected	Not Detected
2,3,6-Trichlorophenol	933-75-5	0.5	µg/L	n.d.	0.05	mg/kg	n.d.	Not Detected	Not Detected
2,4,5-Trichlorophenol	95-95-4	0.5	µg/L	n.d.	0.05	mg/kg	n.d.	Not Detected	Not Detected
2,4,6-Trichlorophenol	88-06-2	0.5	µg/L	n.d.	0.05	mg/kg	n.d.	Not Detected	Not Detected
3,4,5-Trichlorophenol	609-19-8	0.5	µg/L	n.d.	0.05	mg/kg	n.d.	Not Detected	Not Detected
2,3,4,5-Tetrachlorophenol	4901-51-3	0.5	µg/L	n.d.	0.05	mg/kg	n.d.	Not Detected	Not Detected
2,3,4,6-Tetrachlorophenol	58-90-2	0.5	µg/L	n.d.	0.05	mg/kg	n.d.	Not Detected	Not Detected
2,3,5,6-Tetrachlorophenol	935-95-5	0.5	µg/L	n.d.	0.05	mg/kg	n.d.	Not Detected	Not Detected
Pentachlorophenol	87-86-5	0.5	µg/L	n.d.	0.05	mg/kg	n.d.	Not Detected	Not Detected

This document is issued by the Company under its General Conditions of Service printed overleaf or available on request and accessible at http://www.sgs.com/terms_and_conditions.htm and and Terms and Conditions for electronic documents www.sgs.com/terms_e-document.htm. Attention is drawn to the limitation of liability, indemnification and jurisdiction issues defined therein. Any holder of this document is advised that information contained hereon reflects the Company's findings at the time of its intervention only and within the limits of Client's instructions, if any. The Company's sole responsibility is to its Client and this document does not exonerate parties to a transaction from exercising all their rights and obligations under the transaction documents. Any unauthorized alteration, forgery or falsification of the content or appearance of this document is unlawful and offenders may be prosecuted to the fullest extent of the law. Unless otherwise stated the results shown in this test report refer only to the sample(s) tested and such sample(s) are retained for 30 days only. This document cannot be reproduced except in full, without prior approval of the Company.

TEST RESULTS

Factory Name: ERO Dying

Factory Address: 250/6, Javuli Nagar, R.N. Pudur, Erode, 638005

		Sample ID	1242035186 (A)	-	-	1242035186 (B)	Factory Performances		
		Date of Sampling	14.09.2021	-	-	14.09.2021			
		Sampling Location	Waste Water Before Treatment - Collection Tank	-	-	Sludge - Storage bed			
		Sampling Start Time	10:00	-	-	15:30			
		Sampling End Time	16:00	-	-	15:45			
		Date of Sample Received	15.09.2021	-	-	15.09.2021			
Items	CAS No.	Reporting Limit	Units	Raw Waste Water	Reporting Limit	Units	SludgeΦ	Raw Waste Water	Sludge
Azo Dyes									
4,4'-Methylene-Bis(2-Chloroaniline)	101-14-4	0.1	µg/L	n.d.	0.2	mg/kg	n.d.	Not Detected	Not Detected
4,4'-Diaminodiphenylmethane	101-77-9	0.1	µg/L	n.d.	0.2	mg/kg	n.d.	Not Detected	Not Detected
4,4'-Oxydianiline	101-80-4	0.1	µg/L	n.d.	0.2	mg/kg	n.d.	Not Detected	Not Detected
p-Chloroaniline	106-47-8	0.1	µg/L	n.d.	0.2	mg/kg	n.d.	Not Detected	Not Detected
3,3'-Dimethoxybenzidine	119-90-4	0.1	µg/L	n.d.	0.2	mg/kg	n.d.	Not Detected	Not Detected
3,3'-Dimethylbenzidine	119-93-7	0.1	µg/L	n.d.	0.2	mg/kg	n.d.	Not Detected	Not Detected
p-Cresidine	120-71-8	0.1	µg/L	n.d.	0.2	mg/kg	n.d.	Not Detected	Not Detected
2,4,5-Trimethylaniline	137-17-7	0.1	µg/L	n.d.	0.2	mg/kg	n.d.	Not Detected	Not Detected
4,4'-Thiodianiline	139-65-1	0.1	µg/L	n.d.	0.2	mg/kg	n.d.	Not Detected	Not Detected
p-Aminoazobenzene	60-09-3	0.1	µg/L	n.d.	0.2	mg/kg	n.d.	Not Detected	Not Detected
2,4-Diaminoanisole	615-05-4	0.1	µg/L	n.d.	0.2	mg/kg	n.d.	Not Detected	Not Detected
3,3'-Dimethyl-4,4'diaminodiphenylmethane	838-88-0	0.1	µg/L	n.d.	0.2	mg/kg	n.d.	Not Detected	Not Detected
2,6-Xylidine	87-62-7	0.1	µg/L	n.d.	0.2	mg/kg	n.d.	Not Detected	Not Detected
o-Anisidine	90-04-0	0.1	µg/L	n.d.	0.2	mg/kg	n.d.	Not Detected	Not Detected
2-Naphthylamine	91-59-8	0.1	µg/L	n.d.	0.2	mg/kg	n.d.	Not Detected	Not Detected
3,3'-Dichlorobenzidine	91-94-1	0.1	µg/L	n.d.	0.2	mg/kg	n.d.	Not Detected	Not Detected
4-Aminodiphenyl	92-67-1	0.1	µg/L	n.d.	0.2	mg/kg	n.d.	Not Detected	Not Detected
Benzidine	92-87-5	0.1	µg/L	n.d.	0.2	mg/kg	n.d.	Not Detected	Not Detected
o-Toluidine	95-53-4	0.1	µg/L	n.d.	0.2	mg/kg	n.d.	Not Detected	Not Detected
2,4-Xylidine	95-68-1	0.1	µg/L	n.d.	0.2	mg/kg	n.d.	Not Detected	Not Detected
4-Chloro-o-Toluidine	95-69-2	0.1	µg/L	n.d.	0.2	mg/kg	n.d.	Not Detected	Not Detected
2,4-Toluylenediamine	95-80-7	0.1	µg/L	n.d.	0.2	mg/kg	n.d.	Not Detected	Not Detected

This document is issued by the Company under its General Conditions of Service printed overleaf or available on request and accessible at http://www.sgs.com/terms_and_conditions.htm and and Terms and Conditions for electronic documents www.sgs.com/terms_e-document.htm. Attention is drawn to the limitation of liability, indemnification and jurisdiction issues defined therein. Any holder of this document is advised that information contained hereon reflects the Company's findings at the time of its intervention only and within the limits of Client's instructions, if any. The Company's sole responsibility is to its Client and this document does not exonerate parties to a transaction from exercising all their rights and obligations under the transaction documents. Any unauthorized alteration, forgery or falsification of the content or appearance of this document is unlawful and offenders may be prosecuted to the fullest extent of the law. Unless otherwise stated the results shown in this test report refer only to the sample(s) tested and such sample(s) are retained for 30 days only. This document cannot be reproduced except in full, without prior approval of the Company.

TEST RESULTS

Factory Name: ERO Dying

Factory Address: 250/6, Javuli Nagar, R.N. Pudur, Erode, 638005

		Sample ID	1242035186 (A)	-	-	1242035186 (B)	Factory Performances		
		Date of Sampling	14.09.2021	-	-	14.09.2021			
		Sampling Location	Waste Water Before Treatment - Collection Tank	-	-	Sludge - Storage bed			
		Sampling Start Time	10:00	-	-	15:30			
		Sampling End Time	16:00	-	-	15:45			
		Date of Sample Received	15.09.2021	-	-	15.09.2021			
Items	CAS No.	Reporting Limit	Units	Raw Waste Water	Reporting Limit	Units	SludgeΦ	Raw Waste Water	Sludge
o-Aminoazotoluene	97-56-3	0.1	µg/L	n.d.	0.2	mg/kg	n.d.	Not Detected	Not Detected
2-Amino-4-Nitrotoluene	99-55-8	0.1	µg/L	n.d.	0.2	mg/kg	n.d.	Not Detected	Not Detected
Carcinogenic Dyes									
Direct Black 38	1937-37-7	500	µg/L	n.d.	10	mg/kg	n.d.	Not Detected	Not Detected
Direct Blue 6	2602-46-2	500	µg/L	n.d.	10	mg/kg	n.d.	Not Detected	Not Detected
Acid Red 26	3761-53-3	500	µg/L	n.d.	10	mg/kg	n.d.	Not Detected	Not Detected
Basic Red 9	569-61-9	500	µg/L	n.d.	10	mg/kg	n.d.	Not Detected	Not Detected
Direct Red 28	573-58-0	500	µg/L	n.d.	10	mg/kg	n.d.	Not Detected	Not Detected
Basic Violet 14	632-99-5	500	µg/L	n.d.	10	mg/kg	n.d.	Not Detected	Not Detected
Disperse Blue 1	2475-45-8	500	µg/L	n.d.	10	mg/kg	n.d.	Not Detected	Not Detected
Disperse Blue 3	2475-46-9	500	µg/L	n.d.	10	mg/kg	n.d.	Not Detected	Not Detected
Basic Blue 26	2580-56-5	500	µg/L	n.d.	10	mg/kg	n.d.	Not Detected	Not Detected
Basic Green 4 (malachite green chloride)^	569-64-2	500	µg/L	n.d.	10	mg/kg	n.d.	Not Detected	Not Detected
Basic Green 4 (malachite green oxalate)^	2437-29-8	500	µg/L	n.d.	10	mg/kg	n.d.	Not Detected	Not Detected
Basic Green 4 (malachite green)	10309-95-2	500	µg/L	n.d.	10	mg/kg	n.d.	Not Detected	Not Detected
Disperse Orange 11	82-28-0	500	µg/L	n.d.	10	mg/kg	n.d.	Not Detected	Not Detected
Disperse Dyes									
Disperse Yellow 1	119-15-3	50	µg/L	n.d.	2	mg/kg	n.d.	Not Detected	Not Detected
Disperse Blue 102	12222-97-8	50	µg/L	n.d.	2	mg/kg	n.d.	Not Detected	Not Detected
Disperse Blue 106	12223-01-7	50	µg/L	n.d.	2	mg/kg	n.d.	Not Detected	Not Detected
Disperse Yellow 39	12236-29-2	50	µg/L	n.d.	2	mg/kg	n.d.	Not Detected	Not Detected
Disperse Orange 37/59/76	13301-61-6	50	µg/L	n.d.	2	mg/kg	n.d.	Not Detected	Not Detected
Disperse Brown 1	23355-64-8	50	µg/L	n.d.	2	mg/kg	n.d.	Not Detected	Not Detected
Disperse Orange 1	2581-69-3	50	µg/L	n.d.	2	mg/kg	n.d.	Not Detected	Not Detected

This document is issued by the Company under its General Conditions of Service printed overleaf or available on request and accessible at http://www.sgs.com/terms_and_conditions.htm and Terms and Conditions for electronic documents www.sgs.com/terms_e-document.htm. Attention is drawn to the limitation of liability, indemnification and jurisdiction issues defined therein. Any holder of this document is advised that information contained hereon reflects the Company's findings at the time of its intervention only and within the limits of Client's instructions, if any. The Company's sole responsibility is to its Client and this document does not exonerate parties to a transaction from exercising all their rights and obligations under the transaction documents. Any unauthorized alteration, forgery or falsification of the content or appearance of this document is unlawful and offenders may be prosecuted to the fullest extent of the law. Unless otherwise stated the results shown in this test report refer only to the sample(s) tested and such sample(s) are retained for 30 days only. This document cannot be reproduced except in full, without prior approval of the Company.

TEST RESULTS

Factory Name: ERO Dying

Factory Address: 250/6, Javuli Nagar, R.N. Pudur, Erode, 638005

		Sample ID	1242035186 (A)	-	-	1242035186 (B)	Factory Performances		
		Date of Sampling	14.09.2021	-	-	14.09.2021			
		Sampling Location	Waste Water Before Treatment - Collection Tank	-	-	Sludge - Storage bed			
		Sampling Start Time	10:00	-	-	15:30			
		Sampling End Time	16:00	-	-	15:45			
		Date of Sample Received	15.09.2021	-	-	15.09.2021			
Items	CAS No.	Reporting Limit	Units	Raw Waste Water	Reporting Limit	Units	SludgeΦ	Raw Waste Water	Sludge
Disperse Yellow 3	2832-40-8	50	µg/L	n.d.	2	mg/kg	n.d.	Not Detected	Not Detected
Disperse Red 11	2872-48-2	50	µg/L	n.d.	2	mg/kg	n.d.	Not Detected	Not Detected
Disperse Red 1	2872-52-8	50	µg/L	n.d.	2	mg/kg	n.d.	Not Detected	Not Detected
Disperse Red 17	3179-89-3	50	µg/L	n.d.	2	mg/kg	n.d.	Not Detected	Not Detected
Disperse Blue 7	3179-90-6	50	µg/L	n.d.	2	mg/kg	n.d.	Not Detected	Not Detected
Disperse Blue 26	3860-63-7	50	µg/L	n.d.	2	mg/kg	n.d.	Not Detected	Not Detected
Disperse Yellow 49	54824-37-2	50	µg/L	n.d.	2	mg/kg	n.d.	Not Detected	Not Detected
Disperse Blue 35	12222-75-2, 56524-77-7	50	µg/L	n.d.	2	mg/kg	n.d.	Not Detected	Not Detected
Disperse Blue 124	61951-51-7	50	µg/L	n.d.	2	mg/kg	n.d.	Not Detected	Not Detected
Disperse Yellow 9	6373-73-5	50	µg/L	n.d.	2	mg/kg	n.d.	Not Detected	Not Detected
Disperse Orange 3	730-40-5	50	µg/L	n.d.	2	mg/kg	n.d.	Not Detected	Not Detected
Flame Retardants									
Tris(2-chloroethyl) phosphate (TCEP)	115-96-8	5	µg/L	n.d.	1	mg/kg	n.d.	Not Detected	Not Detected
Decabromodiphenyl ethers (DecaBDE)	1163-19-5	5	µg/L	n.d.	1	mg/kg	n.d.	Not Detected	Not Detected
Tris(2,3-dibromopropyl) phosphate (TRIS)	126-72-7	5	µg/L	n.d.	1	mg/kg	n.d.	Not Detected	Not Detected
Pentabromodiphenyl ethers (PentaBDE)	32534-81-9	5	µg/L	n.d.	1	mg/kg	n.d.	Not Detected	Not Detected
Octabromodiphenyl ethers (OctaBDE)	32536-52-0	5	µg/L	n.d.	1	mg/kg	n.d.	Not Detected	Not Detected
Bis(2,3-dibromopropyl)phosphate (BIS)	5412-25-9	5	µg/L	n.d.	1	mg/kg	n.d.	Not Detected	Not Detected
Tris(1-aziridinyl)phosphine oxide (TEPA)	545-55-1	5	µg/L	n.d.	1	mg/kg	n.d.	Not Detected	Not Detected
Polybrominated biphenyls (PBBs)	59536-65-1	5	µg/L	n.d.	1	mg/kg	n.d.	Not Detected	Not Detected
Tetrabromobisphenol A (TBBPA)	79-94-7	5	µg/L	n.d.	1	mg/kg	n.d.	Not Detected	Not Detected
Hexabromocyclododecane (HBCDD)	134237-50-6, 134237-51-7, 134237-52-8, 25637-99-4, 3194-55-6	5	µg/L	n.d.	1	mg/kg	n.d.	Not Detected	Not Detected
2,2-Bis(bromomethyl)-1,3-propanediol (BBMP)	3296-90-0	5	µg/L	n.d.	1	mg/kg	n.d.	Not Detected	Not Detected

This document is issued by the Company under its General Conditions of Service printed overleaf or available on request and accessible at http://www.sgs.com/terms_and_conditions.htm and and Terms and Conditions for electronic documents www.sgs.com/terms_e-document.htm. Attention is drawn to the limitation of liability, indemnification and jurisdiction issues defined therein. Any holder of this document is advised that information contained hereon reflects the Company's findings at the time of its intervention only and within the limits of Client's instructions, if any. The Company's sole responsibility is to its Client and this document does not exonerate parties to a transaction from exercising all their rights and obligations under the transaction documents. Any unauthorized alteration, forgery or falsification of the content or appearance of this document is unlawful and offenders may be prosecuted to the fullest extent of the law. Unless otherwise stated the results shown in this test report refer only to the sample(s) tested and such sample(s) are retained for 30 days only. This document cannot be reproduced except in full, without prior approval of the Company.

TEST RESULTS

Factory Name: ERO Dying

Factory Address: 250/6, Javuli Nagar, R.N. Pudur, Erode, 638005

		Sample ID	1242035186 (A)	-	-	1242035186 (B)			
		Date of Sampling	14.09.2021	-	-	14.09.2021			
		Sampling Location	Waste Water Before Treatment - Collection Tank	-	-	Sludge - Storage bed	Factory Performances		
		Sampling Start Time	10:00	-	-	15:30			
		Sampling End Time	16:00	-	-	15:45			
		Date of Sample Received	15.09.2021	-	-	15.09.2021			
Items	CAS No.	Reporting Limit	Units	Raw Waste Water	Reporting Limit	Units	SludgeΦ	Raw Waste Water	Sludge
Tris(1,3-dichloro-2-propyl) phosphate (TDCPP)	13674-87-8	5	µg/L	n.d.	1	mg/kg	n.d.	Not Detected	Not Detected
Short Chain Chlorinated Paraffins (SCCP), C ₁₀ -C ₁₃	85535-84-8	5	µg/L	n.d.	1	mg/kg	n.d.	Not Detected	Not Detected
Glycols									
Bis(2-methoxyethyl)-ether	111-96-6	50	µg/L	n.d.	10	mg/kg	n.d.	Not Detected	Not Detected
2-Ethoxyethanol	110-80-5	50	µg/L	n.d.	10	mg/kg	n.d.	Not Detected	Not Detected
2-Ethoxyethyl acetate	111-15-9	50	µg/L	n.d.	10	mg/kg	n.d.	Not Detected	Not Detected
Ethylene glycol dimethyl ether	110-71-4	50	µg/L	n.d.	10	mg/kg	n.d.	Not Detected	Not Detected
2-Methoxyethanol	109-86-4	50	µg/L	n.d.	10	mg/kg	n.d.	Not Detected	Not Detected
2-Methoxyethylacetate	110-49-6	50	µg/L	n.d.	10	mg/kg	n.d.	Not Detected	Not Detected
2-Methoxypropylacetate	70657-70-4	50	µg/L	n.d.	10	mg/kg	n.d.	Not Detected	Not Detected
Triethylene glycol dimethyl ether	112-49-2	50	µg/L	n.d.	10	mg/kg	n.d.	Not Detected	Not Detected
Halogenated Solvents									
1,2-Dichloroethane	107-06-2	1	µg/L	n.d.	2	mg/kg	n.d.	Not Detected	Not Detected
Methylene chloride	75-09-2	1	µg/L	n.d.	2	mg/kg	n.d.	Not Detected	Not Detected
Trichloroethene	79-01-6	1	µg/L	n.d.	2	mg/kg	n.d.	Not Detected	Not Detected
Tetrachloroethene	127-18-4	1	µg/L	n.d.	2	mg/kg	n.d.	Not Detected	Not Detected
Organotin Compounds									
Mono-, di- and tri-methyltin derivatives	Multiple	0.01	µg/L	n.d.	0.2	mg/kg	n.d.	Not Detected	Not Detected
Monomethyltin (MMT)	Multiple	0.01	µg/L	n.d.	0.2	mg/kg	n.d.	Not Detected	Not Detected
Dimethyltin (DMT)	Multiple	0.01	µg/L	n.d.	0.2	mg/kg	n.d.	Not Detected	Not Detected
Trimethyltin (TMT)	Multiple	0.01	µg/L	n.d.	0.2	mg/kg	n.d.	Not Detected	Not Detected
Mono-, di- and tri-butyltin derivatives	Multiple	0.01	µg/L	n.d.	0.2	mg/kg	n.d.	Not Detected	Not Detected
Monobutyltin (MBT)	1118-46-3, 78763-54-9	0.01	µg/L	n.d.	0.2	mg/kg	n.d.	Not Detected	Not Detected
Dibutyltin (DBT)	1002-53-5	0.01	µg/L	n.d.	0.2	mg/kg	n.d.	Not Detected	Not Detected
Tributyltin (TBT)	56573-85-4	0.01	µg/L	n.d.	0.2	mg/kg	n.d.	Not Detected	Not Detected

This document is issued by the Company under its General Conditions of Service printed overleaf or available on request and accessible at http://www.sgs.com/terms_and_conditions.htm and and Terms and Conditions for electronic documents www.sgs.com/terms_e-document.htm. Attention is drawn to the limitation of liability, indemnification and jurisdiction issues defined therein. Any holder of this document is advised that information contained hereon reflects the Company's findings at the time of its intervention only and within the limits of Client's instructions, if any. The Company's sole responsibility is to its Client and this document does not exonerate parties to a transaction from exercising all their rights and obligations under the transaction documents. Any unauthorized alteration, forgery or falsification of the content or appearance of this document is unlawful and offenders may be prosecuted to the fullest extent of the law. Unless otherwise stated the results shown in this test report refer only to the sample(s) tested and such sample(s) are retained for 30 days only. This document cannot be reproduced except in full, without prior approval of the Company.

TEST RESULTS

Factory Name: ERO Dying

Factory Address: 250/6, Javuli Nagar, R.N. Pudur, Erode, 638005

		Sample ID	1242035186 (A)	-	-	1242035186 (B)	Factory Performances		
		Date of Sampling	14.09.2021	-	-	14.09.2021			
		Sampling Location	Waste Water Before Treatment - Collection Tank	-	-	Sludge - Storage bed			
		Sampling Start Time	10:00	-	-	15:30			
		Sampling End Time	16:00	-	-	15:45			
		Date of Sample Received	15.09.2021	-	-	15.09.2021			
Items	CAS No.	Reporting Limit	Units	Raw Waste Water	Reporting Limit	Units	SludgeΦ	Raw Waste Water	Sludge
Mono-, di- and tri-phenyltin derivatives	Multiple	0.01	µg/L	n.d.	0.2	mg/kg	n.d.	Not Detected	Not Detected
Monophenyltin (MPHT)	Multiple	0.01	µg/L	n.d.	0.2	mg/kg	n.d.	Not Detected	Not Detected
Diphenyltin (DPHT)	Multiple	0.01	µg/L	n.d.	0.2	mg/kg	n.d.	Not Detected	Not Detected
Triphenyltin (TPHT)	892-20-6, 668-34-8	0.01	µg/L	n.d.	0.2	mg/kg	n.d.	Not Detected	Not Detected
Mono-, di- and tri-octyltin derivatives	Multiple	0.01	µg/L	n.d.	0.2	mg/kg	n.d.	Not Detected	Not Detected
Monooctyltin (MOT)	15231-57-9	0.01	µg/L	n.d.	0.2	mg/kg	n.d.	Not Detected	Not Detected
Diocetyl tin (DOT)	94410-05-6, 12531-44-4	0.01	µg/L	n.d.	0.2	mg/kg	n.d.	Not Detected	Not Detected
Triocetyl tin (TOT)	Multiple	0.01	µg/L	n.d.	0.2	mg/kg	n.d.	Not Detected	Not Detected
Perfluorinated / Polyfluorinated Chemicals (PFCs)									
PFOS	1763-23-1	0.01	µg/L	n.d.	0.10	mg/kg	n.d.	Not Detected	Not Detected
PFOA	335-67-1	0.01	µg/L	n.d.	0.10	mg/kg	n.d.	Not Detected	Not Detected
PFBS	375-73-5, 59933-66-3, 29420-49-3, 29420-43-3	0.01	µg/L	n.d.	0.10	mg/kg	n.d.	Not Detected	Not Detected
PFHxA	307-24-4	0.01	µg/L	n.d.	0.10	mg/kg	n.d.	Not Detected	Not Detected
8:2 FTOH	678-39-7	1	µg/L	n.d.	1	mg/kg	n.d.	Not Detected	Not Detected
6:2 FTOH	647-42-7	1	µg/L	n.d.	1	mg/kg	n.d.	Not Detected	Not Detected
Phthalates									
Di(2-Ethyl Hexyl) Phthalate (DEHP)	117-81-7	10	µg/L	n.d.	2	mg/kg	n.d.	Not Detected	Not Detected
Bis(2-methoxyethyl)phthalate (DMEP)	117-82-8	10	µg/L	n.d.	2	mg/kg	n.d.	Not Detected	Not Detected
Di-N-Octyl Phthalate (DNOP)	117-84-0	10	µg/L	n.d.	2	mg/kg	n.d.	Not Detected	Not Detected
Di-Iso-Decyl Phthalate (DIDP)	26761-40-0, 68515-49-1	10	µg/L	n.d.	2	mg/kg	n.d.	Not Detected	Not Detected
Di-Iso-Nonyl Phthalate (DINP)	28553-12-0, 68515-48-0	10	µg/L	n.d.	2	mg/kg	n.d.	Not Detected	Not Detected
Di-N-Hexyl Phthalate (DNHP)	84-75-3	10	µg/L	n.d.	2	mg/kg	n.d.	Not Detected	Not Detected
Dibutyl Phthalate (DBP)	84-74-2	10	µg/L	n.d.	2	mg/kg	n.d.	Not Detected	Not Detected
Benzyl Butyl Phthalate (BBP)	85-68-7	10	µg/L	n.d.	2	mg/kg	n.d.	Not Detected	Not Detected

This document is issued by the Company under its General Conditions of Service printed overleaf or available on request and accessible at http://www.sgs.com/terms_and_conditions.htm and and Terms and Conditions for electronic documents www.sgs.com/terms_e-document.htm. Attention is drawn to the limitation of liability, indemnification and jurisdiction issues defined therein. Any holder of this document is advised that information contained hereon reflects the Company's findings at the time of its intervention only and within the limits of Client's instructions, if any. The Company's sole responsibility is to its Client and this document does not exonerate parties to a transaction from exercising all their rights and obligations under the transaction documents. Any unauthorized alteration, forgery or falsification of the content or appearance of this document is unlawful and offenders may be prosecuted to the fullest extent of the law. Unless otherwise stated the results shown in this test report refer only to the sample(s) tested and such sample(s) are retained for 30 days only. This document cannot be reproduced except in full, without prior approval of the Company.

TEST RESULTS

Factory Name: ERO Dying

Factory Address: 250/6, Javuli Nagar, R.N. Pudur, Erode, 638005

		Sample ID	1242035186 (A)	-	-	1242035186 (B)	Factory Performances		
		Date of Sampling	14.09.2021	-	-	14.09.2021			
		Sampling Location	Waste Water Before Treatment - Collection Tank	-	-	Sludge - Storage bed			
		Sampling Start Time	10:00	-	-	15:30			
		Sampling End Time	16:00	-	-	15:45			
		Date of Sample Received	15.09.2021	-	-	15.09.2021			
Items	CAS No.	Reporting Limit	Units	Raw Waste Water	Reporting Limit	Units	SludgeΦ	Raw Waste Water	Sludge
Dinonyl phthalate (DNP)	84-76-4	10	µg/L	n.d.	2	mg/kg	n.d.	Not Detected	Not Detected
Diethyl Phthalate (DEP)	84-66-2	10	µg/L	n.d.	2	mg/kg	n.d.	Not Detected	Not Detected
Di-N-Propyl Phthalate (DPRP)	131-16-8	10	µg/L	n.d.	2	mg/kg	n.d.	Not Detected	Not Detected
Di-Iso-Butyl Phthalate (DIBP)	84-69-5	10	µg/L	n.d.	2	mg/kg	n.d.	Not Detected	Not Detected
Dicyclohexyl Phthalate (DCHP)	84-61-7	10	µg/L	n.d.	2	mg/kg	n.d.	Not Detected	Not Detected
Di-Iso-Octyl Phthalate (DIOP)	27554-26-3	10	µg/L	n.d.	2	mg/kg	n.d.	Not Detected	Not Detected
1,2-Benzenedicarboxylic acid, Di-C7-11 Branched and Linear Alkyl Esters (DHNUP)	68515-42-4	10	µg/L	n.d.	2	mg/kg	n.d.	Not Detected	Not Detected
1,2-Benzenedicarboxylic acid, Di-C6-8 Branched Alkyl Esters, C7-rich (DIHP)	71888-89-6	10	µg/L	n.d.	2	mg/kg	n.d.	Not Detected	Not Detected
Polycyclic Aromatic Hydrocarbons (PAHs)									
Benzo[a]pyrene	50-32-8	1	µg/L	n.d.	0.2	mg/kg	n.d.	Not Detected	Not Detected
Anthracene	120-12-7	1	µg/L	n.d.	0.2	mg/kg	n.d.	Not Detected	Not Detected
Pyrene	129-00-0	1	µg/L	n.d.	0.2	mg/kg	n.d.	Not Detected	Not Detected
Benzo[ghi]perylene	191-24-2	1	µg/L	n.d.	0.2	mg/kg	n.d.	Not Detected	Not Detected
Benzo[e]pyrene	192-97-2	1	µg/L	n.d.	0.2	mg/kg	n.d.	Not Detected	Not Detected
Indeno[1,2,3-cd]pyrene	193-39-5	1	µg/L	n.d.	0.2	mg/kg	n.d.	Not Detected	Not Detected
Benzo[j]fluoranthene	205-82-3	1	µg/L	n.d.	0.2	mg/kg	n.d.	Not Detected	Not Detected
Benzo[b]fluoranthene	205-99-2	1	µg/L	n.d.	0.2	mg/kg	n.d.	Not Detected	Not Detected
Fluoranthene	206-44-0	1	µg/L	n.d.	0.2	mg/kg	n.d.	Not Detected	Not Detected
Benzo[k]fluoranthene	207-08-9	1	µg/L	n.d.	0.2	mg/kg	n.d.	Not Detected	Not Detected
Acenaphthylene	208-96-8	1	µg/L	n.d.	0.2	mg/kg	n.d.	Not Detected	Not Detected
Chrysene	218-01-9	1	µg/L	n.d.	0.2	mg/kg	n.d.	Not Detected	Not Detected
Dibenz[a,h]anthracene	53-70-3	1	µg/L	n.d.	0.2	mg/kg	n.d.	Not Detected	Not Detected
Benzo[a]anthracene	56-55-3	1	µg/L	n.d.	0.2	mg/kg	n.d.	Not Detected	Not Detected

This document is issued by the Company under its General Conditions of Service printed overleaf or available on request and accessible at http://www.sgs.com/terms_and_conditions.htm and Terms and Conditions for electronic documents www.sgs.com/terms_e-document.htm. Attention is drawn to the limitation of liability, indemnification and jurisdiction issues defined therein. Any holder of this document is advised that information contained hereon reflects the Company's findings at the time of its intervention only and within the limits of Client's instructions, if any. The Company's sole responsibility is to its Client and this document does not exonerate parties to a transaction from exercising all their rights and obligations under the transaction documents. Any unauthorized alteration, forgery or falsification of the content or appearance of this document is unlawful and offenders may be prosecuted to the fullest extent of the law. Unless otherwise stated the results shown in this test report refer only to the sample(s) tested and such sample(s) are retained for 30 days only. This document cannot be reproduced except in full, without prior approval of the Company.

TEST RESULTS

Factory Name: ERO Dying

Factory Address: 250/6, Javuli Nagar, R.N. Pudur, Erode, 638005

		Sample ID	1242035186 (A)	-	-	1242035186 (B)			
		Date of Sampling	14.09.2021	-	-	14.09.2021			
		Sampling Location	Waste Water Before Treatment - Collection Tank	-	-	Sludge - Storage bed	Factory Performances		
		Sampling Start Time	10:00	-	-	15:30			
		Sampling End Time	16:00	-	-	15:45			
		Date of Sample Received	15.09.2021	-	-	15.09.2021			
Items	CAS No.	Reporting Limit	Units	Raw Waste Water	Reporting Limit	Units	Sludge Φ	Raw Waste Water	Sludge
Acenaphthene	83-32-9	1	$\mu\text{g/L}$	n.d.	0.2	mg/kg	n.d.	Not Detected	Not Detected
Phenanthrene	85-01-8	1	$\mu\text{g/L}$	n.d.	0.2	mg/kg	n.d.	Not Detected	Not Detected
Fluorene	86-73-7	1	$\mu\text{g/L}$	n.d.	0.2	mg/kg	n.d.	Not Detected	Not Detected
Naphthalene	91-20-3	1	$\mu\text{g/L}$	n.d.	0.2	mg/kg	n.d.	Not Detected	Not Detected
Volatile Organic Compounds (VOCs)									
Benzene	71-43-2	1	$\mu\text{g/L}$	n.d.	2	mg/kg	n.d.	Not Detected	Not Detected
Xylene	1330-20-7	1	$\mu\text{g/L}$	n.d.	2	mg/kg	n.d.	Not Detected	Not Detected
o-cresol	95-48-7	1	$\mu\text{g/L}$	n.d.	2	mg/kg	n.d.	Not Detected	Not Detected
p-cresol	106-44-5	1	$\mu\text{g/L}$	n.d.	2	mg/kg	n.d.	Not Detected	Not Detected
m-cresol	108-39-4	1	$\mu\text{g/L}$	n.d.	2	mg/kg	n.d.	Not Detected	Not Detected
Additional Parameters									
Dry Mass (Total Solids)	-	-	-	-	-	%	22.7	-	-

Remarks:

"n.d." = Not Detected

"N/A" = Not Tested

"-" = Not Required to be Test

^The test result is based on the calculation of selected element(s) and to the worst-case scenario

Φ Sludge results are reported based on dry mass

This document is issued by the Company under its General Conditions of Service printed overleaf or available on request and accessible at http://www.sgs.com/terms_and_conditions.htm and and Terms and Conditions for electronic documents www.sgs.com/terms_e-document.htm. Attention is drawn to the limitation of liability, indemnification and jurisdiction issues defined therein. Any holder of this document is advised that information contained hereon reflects the Company's findings at the time of its intervention only and within the limits of Client's instructions, if any. The Company's sole responsibility is to its Client and this document does not exonerate parties to a transaction from exercising all their rights and obligations under the transaction documents. Any unauthorized alteration, forgery or falsification of the content or appearance of this document is unlawful and offenders may be prosecuted to the fullest extent of the law. Unless otherwise stated the results shown in this test report refer only to the sample(s) tested and such sample(s) are retained for 30 days only. This document cannot be reproduced except in full, without prior approval of the Company.

TEST PARAMETERS

Factory Name: ERO Dying

Factory Address: 250/6, Javuli Nagar, R.N. Pudur, Erode, 638005

ITEMS	CAS No.	METHODS	ZDHC REQUIREMENTS			Units
			Foundational Limit	Progressive Limit	Aspirational Limit	
Anions						
Cyanide	-	<u>Sludge:</u> With reference to USEPA 9013, USEPA 9014, USEPA 9213, ISO 11262, HJ 745 or CN converted to HCN by reflux-distillation to NaOH followed by colourimetry or ISE	0.2	0.1	0.05	mg/L
Metals						
Total Antimony (Sb)	7440-36-0		0.1	0.05	0.01	mg/L
Total Chromium (Cr)	7440-47-3		0.2	0.1	0.05	mg/L
Total Cobalt (Co)	7440-48-4	<u>Wastewater:</u> With reference to USEPA 200.7, USEPA 200.8, USEPA 6010C, USEPA 6020A, ISO 11885, ISO 12846, ISO 17852, ISO 18412, GB 7466, GB 7467, GB 7472, GB 7475, GB 11907, HJ 597, HJ 700 or acid digestion followed by ICP or ICP/MS analysis	0.05	0.02	0.01	mg/L
Total Copper (Cu)	7440-50-8		1	0.5	0.25	mg/L
Total Nickel (Ni)	7440-02-0	<u>Sludge:</u> With reference to USEPA 3050, USEPA 3051A, USEPA 3060A, USEPA 6010D, USEPA 6020B, USEPA 7471B or acid/peroxide digestion followed by ICP or ICP/MS analysis	0.2	0.1	0.05	mg/L
Total Silver (Ag)	7440-22-4		0.1	0.05	0.005	mg/L
Total Zinc (Zn)	7440-66-6		5.0	1.0	0.5	mg/L
Total Arsenic (As)	7440-38-2		0.05	0.09	0.005	mg/L
Total Cadmium (Cd)	7440-43-9		0.1	0.05	0.01	mg/L
Hexavalent Chromium (Cr-VI)	7440-47-3, 18540-29-9	<u>Wastewater:</u> With reference to USEPA 218.6, ISO 18412, GB 7467 or solvent extraction and derivatisation followed by UV/VIS analysis <u>Sludge:</u> With reference to USEPA 7196, USEPA 7199 or alkaline digestion followed by colourimetric UV/VIS or colourimetric IC analysis	0.05	0.420	0.001	mg/L
Total Lead (Pb)	7439-92-1	<u>Wastewater:</u> With reference to USEPA 200.7, USEPA 200.8, USEPA 6010C, USEPA 6020A, ISO 11885, ISO 12846, ISO 17852, ISO 18412, GB 7466, GB 7467, GB 7472, GB 7475, GB 11907, HJ 597, HJ 700 or acid digestion followed by ICP or ICP/MS analysis <u>Sludge:</u> With reference to USEPA 3050, USEPA 3051A, USEPA 3060A, USEPA 6010D, USEPA 6020B, USEPA 7471B or acid/peroxide digestion followed by CVAA, ICP or ICP/MS analysis	0.1	0.05	0.01	mg/L
Total Mercury (Hg)	7439-97-6		0.01	0.005	0.001	mg/L
Alkylphenols (APs) and Alkylphenol Ethoxylates (APEOs)						
NP / OP		<u>Wastewater:</u> With reference to ISO 18857-2 or ASTM D7065 followed by GC/MS or LC/MS(-MS) analysis <u>Sludge:</u> With reference to USEPA 3540/3541, USEPA 3550, USEPA 3560, ISO 18857-2 or ASTM D7065 followed by GC/MS or LC/MS analysis				
NPEO / OPEO		<u>Wastewater:</u> With reference to ISO 18254-1, ISO 18857-2 or ASTM D7065 followed by GC/MS or LC/MS analysis <u>Sludge:</u> With reference to ISO 18254-1, ISO 18857-2 or ASTM D7065 followed by GC/MS or LC/MS analysis				

This document is issued by the Company under its General Conditions of Service printed overleaf or available on request and accessible at http://www.sgs.com/terms_and_conditions.htm and and Terms and Conditions for electronic documents www.sgs.com/terms_e-document.htm. Attention is drawn to the limitation of liability, indemnification and jurisdiction issues defined therein. Any holder of this document is advised that information contained hereon reflects the Company's findings at the time of its intervention only and within the limits of Client's instructions, if any. The Company's sole responsibility is to its Client and this document does not exonerate parties to a transaction from exercising all their rights and obligations under the transaction documents. Any unauthorized alteration, forgery or falsification of the content or appearance of this document is unlawful and offenders may be prosecuted to the fullest extent of the law. Unless otherwise stated the results shown in this test report refer only to the sample(s) tested and such sample(s) are retained for 30 days only. This document cannot be reproduced except in full, without prior approval of the Company.

TEST PARAMETERS

Factory Name: ERO Dying

Factory Address: 250/6, Javuli Nagar, R.N. Pudur, Erode, 638005

ITEMS	CAS No.	METHODS	ZDHC REQUIREMENTS			Units
			Foundational Limit	Progressive Limit	Aspirational Limit	
Chlorobenzenes and Chlorotoluenes (COCs)		<u>Wastewater:</u> With reference to USEPA 8260B, USEPA 8270D or solvent extraction followed by GC/MS analysis <u>Sludge:</u> With reference to USEPA 3540/3541, USEPA 3550, USEPA 3560, USEPA 3650, USEPA 8270 or solvent extraction followed by GC/MS analysis		-		
Chlorophenols		<u>Wastewater:</u> With reference to USEPA 8270D, ISO 14154 or solvent extraction and derivatisation with KOH, acetic anhydride followed by GC/MS analysis <u>Sludge:</u> With reference to ISO 14154, acid/base liquid extraction, acetylation or liquid/liquid extraction followed by GC/MS analysis		-		
Azo Dyes		<u>Wastewater:</u> With reference to USEPA 8270D, EN 14362-1, EN 14362-3 or solvent extraction with sodium dithionite reduction followed by GC/MS or LC/MS analysis <u>Sludge:</u> With reference to ISO 14362-1, ISO 14362-3 or solvent extraction with sodium dithionite reduction followed by GC/MS or LC/MS analysis		-		
				12		
Carcinogenic Dyes		<u>Wastewater:</u> Solvent extraction followed by LC/MS analysis <u>Sludge:</u> With reference to ISO 16373 or solvent extraction followed by LC/MS analysis		-		
Disperse Dyes		<u>Wastewater:</u> Solvent extraction followed by LC/MS analysis <u>Sludge:</u> With reference to ISO 16373 or solvent extraction followed by LC/MS analysis		-		
Flame Retardants		<u>Wastewater:</u> With reference to USEPA 527, USEPA 8270, USEPA 8321B, ISO 22032 or solvent extraction followed by GC/MS or LC/MS analysis <u>Sludge:</u> With reference to ISO 22032 or solvent extraction followed by GC/MS or LC/MS analysis		-		
Glycols		<u>Wastewater:</u> With reference to USEPA 8270 or solvent extraction followed by GC/MS or LC/MS analysis <u>Sludge:</u> With reference to USEPA 8270D, ISO 22892 or solvent extraction followed by GC/MS or LC/MS analysis		-		
Halogenated Solvents		<u>Wastewater:</u> With reference to USEPA 8260B, Purge-and-Trap, Headspace or solvent extraction followed by GC/MS analysis <u>Sludge:</u> With reference to USEPA 5035, USEPA 50211, USEPA 8010 or solvent extraction followed by GC/MS analysis		-		
Organotin Compounds		<u>Wastewater:</u> With reference to ISO 17353 and derivatisation with sodium diethyl dithiocarbamate followed by GC/MS analysis <u>Sludge:</u> With reference to ISO 23161 and derivatisation with sodium diethyl dithiocarbamate followed by GC/MS analysis		-		

This document is issued by the Company under its General Conditions of Service printed overleaf or available on request and accessible at http://www.sgs.com/terms_and_conditions.htm and and Terms and Conditions for electronic documents www.sgs.com/terms_e-document.htm. Attention is drawn to the limitation of liability, indemnification and jurisdiction issues defined therein. Any holder of this document is advised that information contained hereon reflects the Company's findings at the time of its intervention only and within the limits of Client's instructions, if any. The Company's sole responsibility is to its Client and this document does not exonerate parties to a transaction from exercising all their rights and obligations under the transaction documents. Any unauthorized alteration, forgery or falsification of the content or appearance of this document is unlawful and offenders may be prosecuted to the fullest extent of the law. Unless otherwise stated the results shown in this test report refer only to the sample(s) tested and such sample(s) are retained for 30 days only. This document cannot be reproduced except in full, without prior approval of the Company.

TEST PARAMETERS

Factory Name: ERO Dying

Factory Address: 250/6, Javuli Nagar, R.N. Pudur, Erode, 638005

ITEMS	CAS No.	METHODS	ZDHC REQUIREMENTS			Units
			Foundational Limit	Progressive Limit	Aspirational Limit	
Perfluorinated / Polyfluorinated Chemicals (PFCs)						
FTOHs (Non-ionic)		<u>Wastewater:</u> With reference to DIN38407-42 or CEN/TS 15968 and derivatisation with acetic anhydride followed by GC/MS analysis <u>Sludge:</u> With reference to DIN38407-42 and derivatisation with acetic anhydride followed by GC/MS analysis		-		
Others (Ionic)		<u>Wastewater:</u> With reference to DIN38407-42 or CEN/TS 15968 followed by LCMS or LC/MS(-MS) analysis <u>Sludge:</u> With reference to DIN38407-42 followed by LCMS or LC/MS(-MS) analysis				
Phthalates		<u>Wastewater:</u> With reference to USEPA 8270D, ISO 18856 or solvent extraction followed by GC/MS analysis <u>Sludge:</u> With reference to USEPA 3540/3541, USEPA 3550, USEPA 3560, ISO 18856 or solvent extraction followed by GC/MS analysis		-		
Polycyclic Aromatic Hydrocarbons (PAHs)		<u>Wastewater:</u> With reference to USEPA 8270, DIN 38407-39 or solvent extraction followed by GC/MS analysis <u>Sludge:</u> With reference to USEPA 3540/3541, USEPA 3550, USEPA 3560, USEPA 3650, USEPA 8270 or solvent extraction followed by GC/MS analysis		-		
Volatile Organic Compounds (VOCs)		<u>Wastewater:</u> With reference to USEPA 8260B, Purge-and-Trap, Headspace or solvent extraction followed by GC/MS analysis <u>Sludge:</u> With reference to USEPA 5035, USEPA 5021, USEPA 8260, DIN 38407 Part 43 or solvent extraction followed by GC/MS analysis		-		

This document is issued by the Company under its General Conditions of Service printed overleaf or available on request and accessible at http://www.sgs.com/terms_and_conditions.htm and and Terms and Conditions for electronic documents www.sgs.com/terms_e-document.htm. Attention is drawn to the limitation of liability, indemnification and jurisdiction issues defined therein. Any holder of this document is advised that information contained hereon reflects the Company's findings at the time of its intervention only and within the limits of Client's instructions, if any. The Company's sole responsibility is to its Client and this document does not exonerate parties to a transaction from exercising all their rights and obligations under the transaction documents. Any unauthorized alteration, forgery or falsification of the content or appearance of this document is unlawful and offenders may be prosecuted to the fullest extent of the law. Unless otherwise stated the results shown in this test report refer only to the sample(s) tested and such sample(s) are retained for 30 days only. This document cannot be reproduced except in full, without prior approval of the Company.

PIPING PLAN

Factory Name: ERO Dying

Factory Address: 250/6, Javuli Nagar, R.N. Pudur, Erode, 638005

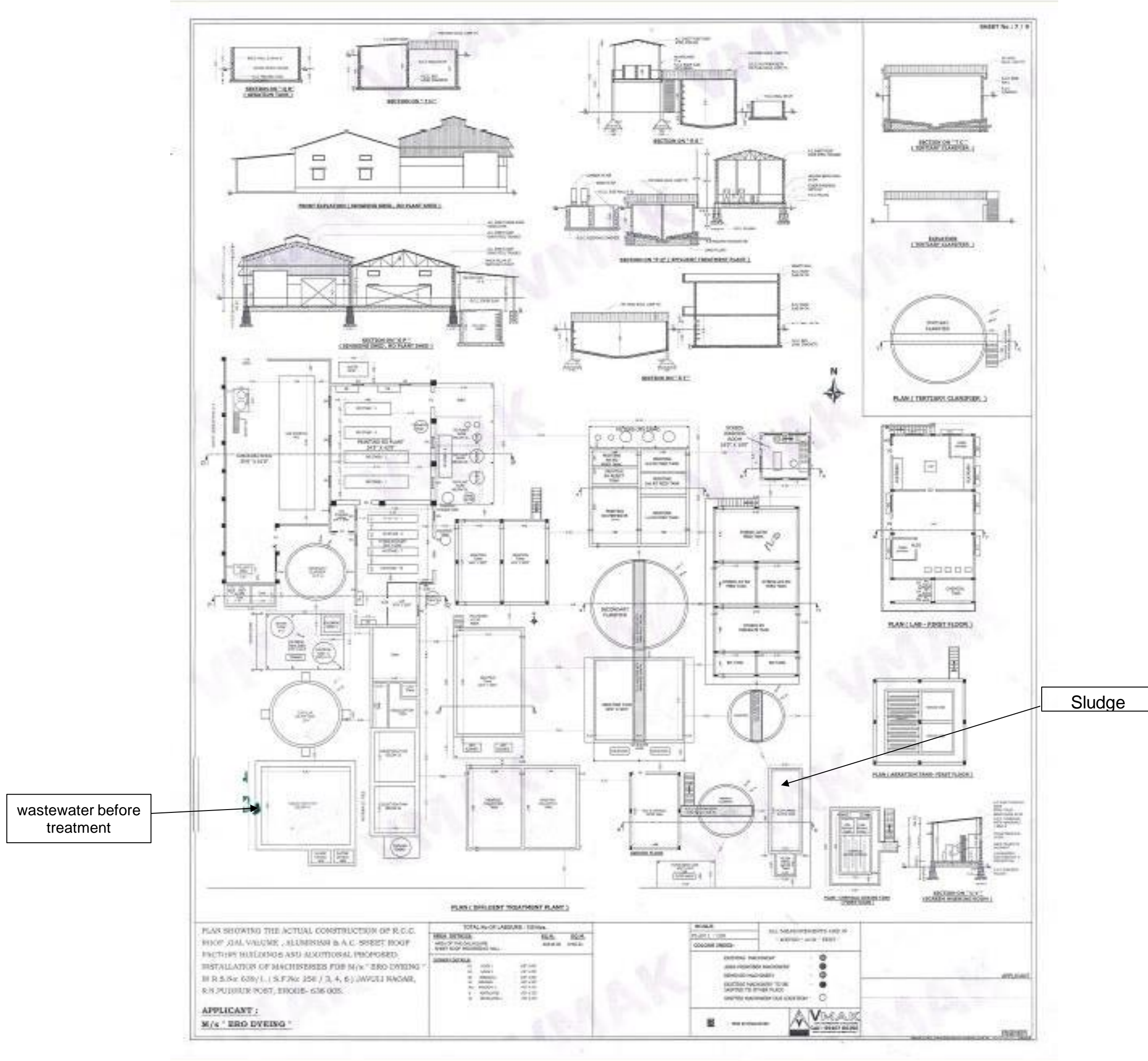

This document is issued by the Company under its General Conditions of Service printed overleaf or available on request and accessible at http://www.sgs.com/terms_and_conditions.htm and and Terms and Conditions for electronic documents www.sgs.com/terms_e-document.htm. Attention is drawn to the limitation of liability, indemnification and jurisdiction issues defined therein. Any holder of this document is advised that information contained hereon reflects the Company's findings at the time of its intervention only and within the limits of Client's instructions, if any. The Company's sole responsibility is to its Client and this document does not exonerate parties to a transaction from exercising all their rights and obligations under the transaction documents. Any unauthorized alteration, forgery or falsification of the content or appearance of this document is unlawful and offenders may be prosecuted to the fullest extent of the law. Unless otherwise stated the results shown in this test report refer only to the sample(s) tested and such sample(s) are retained for 30 days only. This document cannot be reproduced except in full, without prior approval of the Company.

SAMPLING PHOTOS

Factory Name: ERO Dying

Factory Address: 250/6, Javuli Nagar, R.N. Pudur, Erode, 638005

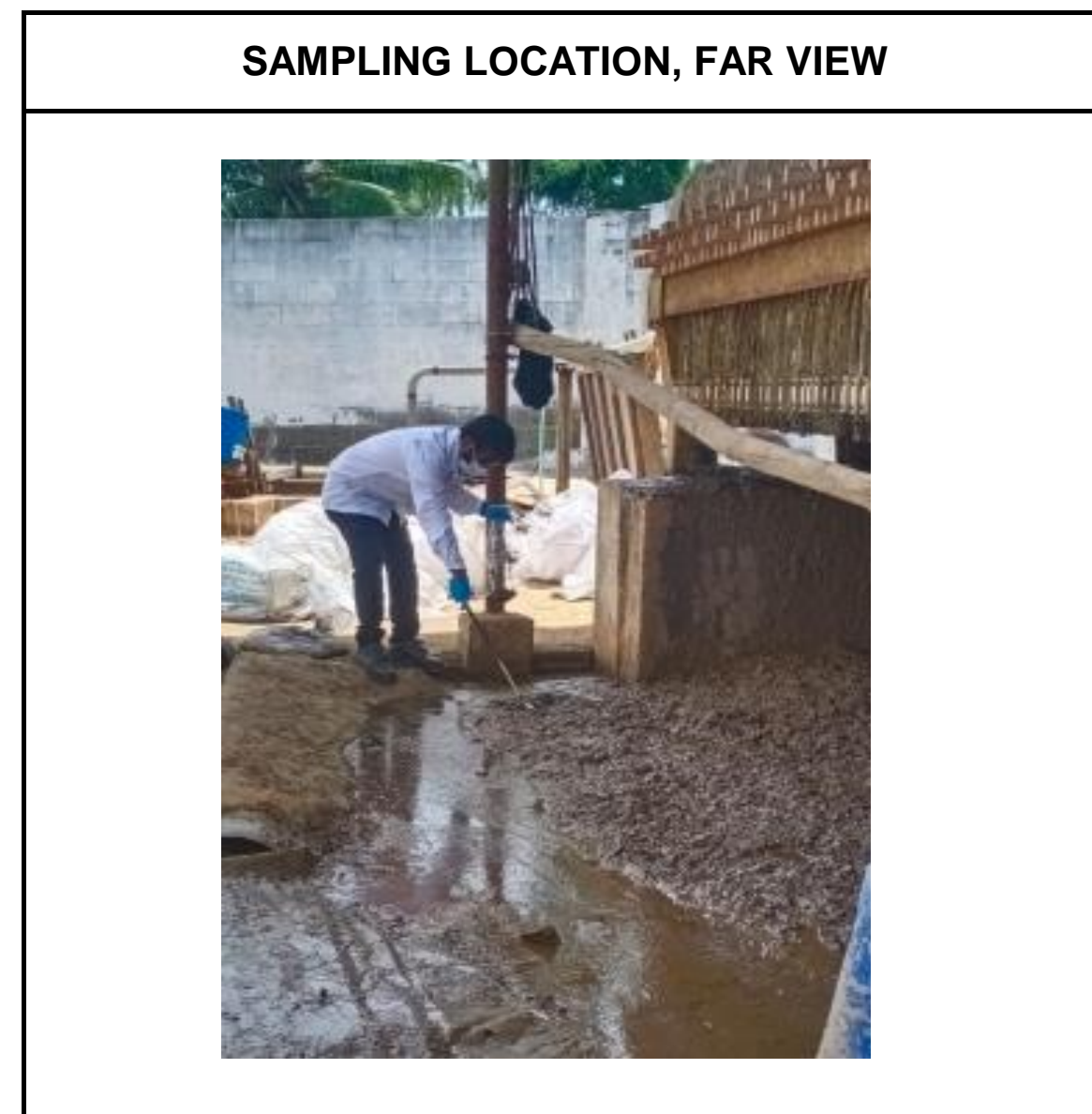
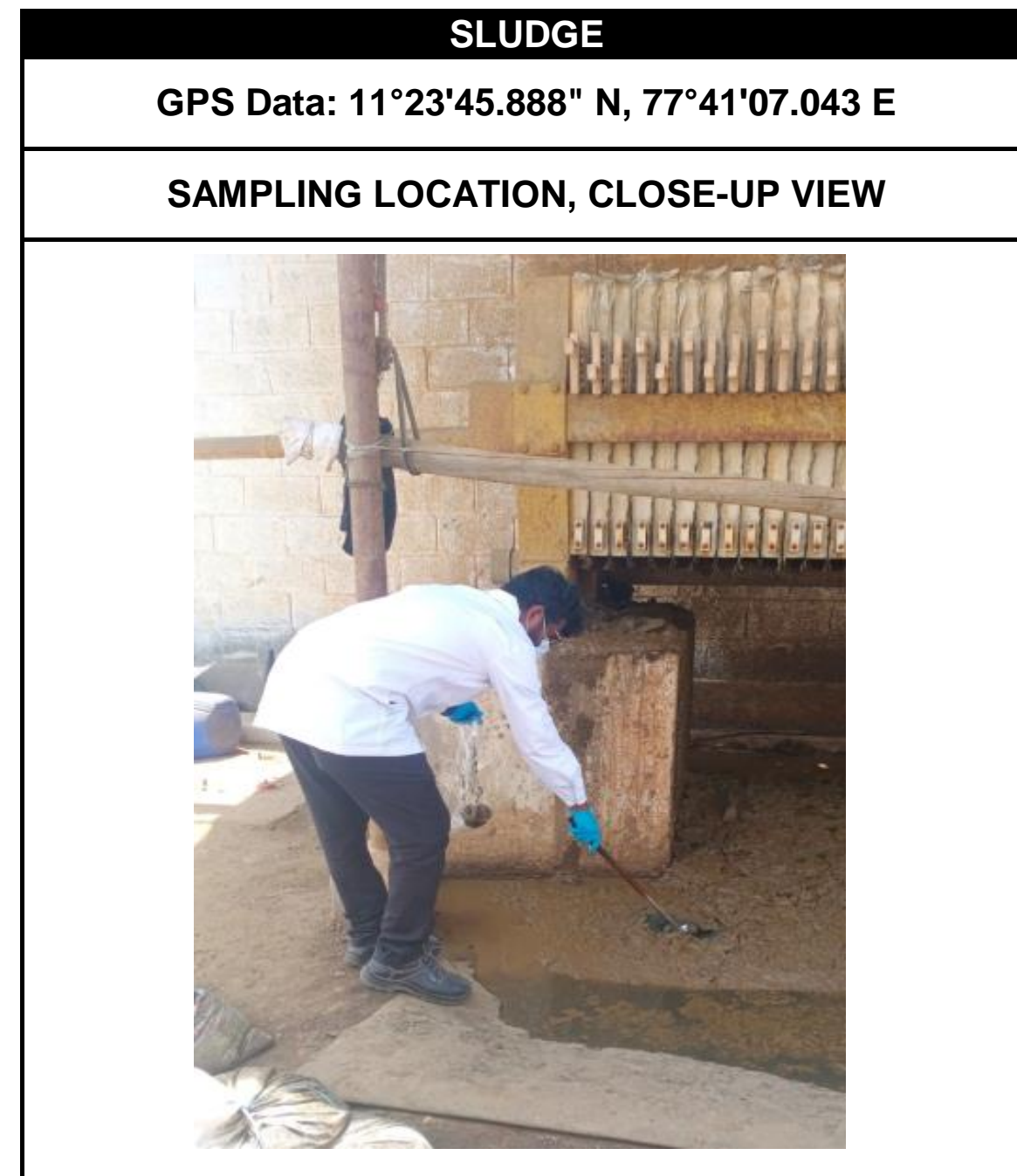

This document is issued by the Company under its General Conditions of Service printed overleaf or available on request and accessible at http://www.sgs.com/terms_and_conditions.htm and and Terms and Conditions for electronic documents www.sgs.com/terms_e-document.htm. Attention is drawn to the limitation of liability, indemnification and jurisdiction issues defined therein. Any holder of this document is advised that information contained hereon reflects the Company's findings at the time of its intervention only and within the limits of Client's instructions, if any. The Company's sole responsibility is to its Client and this document does not exonerate parties to a transaction from exercising all their rights and obligations under the transaction documents. Any unauthorized alteration, forgery or falsification of the content or appearance of this document is unlawful and offenders may be prosecuted to the fullest extent of the law. Unless otherwise stated the results shown in this test report refer only to the sample(s) tested and such sample(s) are retained for 30 days only. This document cannot be reproduced except in full, without prior approval of the Company.